



MEYRAT STANDARDS

HIGH PRECISION SPINDLES



Looking for a competitive advantage?

Founded 1947 in Bienne a region recognized as the Swiss birthplace of machine tools, **MEYRAT SA** develops and manufactures customized and MEYRAT standard spindles for small to medium sized machines.

MEYRAT helps you to gain competitive advantage through spindle technology with:

“Superior performance”

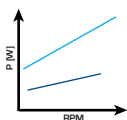

- Better torque
- More dynamics
- Less consumption
- High RPM
- Smaller diameter
- Etc.

“Higher precision”



- Lower run-out
- Less vibrations
- Better thermal stability
- Etc.

“Higher reliability”



- MEYRAT swiss conception
- MEYRAT craftsmanship
- Best components chosen
- Higher uptime achieved
- Etc.

“Better value add for you and your customers”



- Innovative solutions
- New features like automatic tool change
- New controls, measuring & monitoring options
- Etc.

“Efficient services”



- MEYRAT know-how
- SpinCare, revision and repair service
- Performed by our skilled technicians
- Etc.

Table of contents



EDITORIAL	2
TABLE OF CONTENTS	3
INDUSTRIES	4
APPLICATIONS	5
LEADING-EDGE TECHNOLOGY	6
MHF-HIGH FREQUENCY SPINDLES	8
MHF-16	10
MHF-19	11
MHF-20	12
MHF-22	14
MHF-25	16
MHF-30	17
MHF-35 AUTOMATIC TOOL CHANGE	18
MHF-45 AUTOMATIC TOOL CHANGE	19
MHF-80	20
MHT-HIGH TORQUE SPINDLES	22
MHT-25	24
MHT-30	25
MHT-30 IKZ	26
MHT-30 AUTOMATIC TOOL CHANGE	27
MHT-45 AUTOMATIC TOOL CHANGE	29
MDS-DRESSING SPINDLES	30
MDS-38	32
MDS-58	33
MDS-72	34
MDS-76 / 78	35
SPINDLE SYSTEM & COUPLING	36
ATC SPINDLE SYSTEM & DRIVE	38
ACCESSORIES TABLE	40
CONTACT	41

Industries

Your experienced and reliable partner for industries like:



Aerospace



Automotive



Dental



Electronics



Medtech



Optics



Tooling



Watches



Wood

Applications



Leading solutions for your applications requirements, such as:

Cutting



Dressing



Drilling



EDM



Etching



Grinding



Swiss lathing



Milling



Turning



Bearing system

Hybrid ball bearings: ultra-resistant steel/inox ring with ceramic balls lubricated with grease or air-oil that can withstand very high temperatures and speeds.

Classic ball bearings:

Steel/inox ball bearings satisfying high requirements on speed strength, load capacity and stiffness.

Ceramic ball bearings:

For extreme environment and conditions (e.g. corrosion, space conditions, ...)

Lubrication

Grease or Air-Oil (with diffusor)

Cooling systems

Air cooling system: air forced or natural convection.

- Low consumption
- Environment protection
- Protection by air overpressure

Liquid cooling system: water or oil to stabilize spindle temperature regardless of its rotating speed:

- Perfect precision and stability at tool end
- Temperature stability
- Long lifetime and reliability

Through-spindle coolant (IKZ)

Internal coolant (through the tool) system

- High pressure by rotary seal.
- Dispenser crown.
- Auxiliary nozzle.

Tool interface

Most efficient and reliable standard clamping systems of the market:

- HSK, ISO, Capto, ETA, ER and outside Ø.
- Customized tool interface system according to customer's requests.

Clamping system

Manual or automatic.

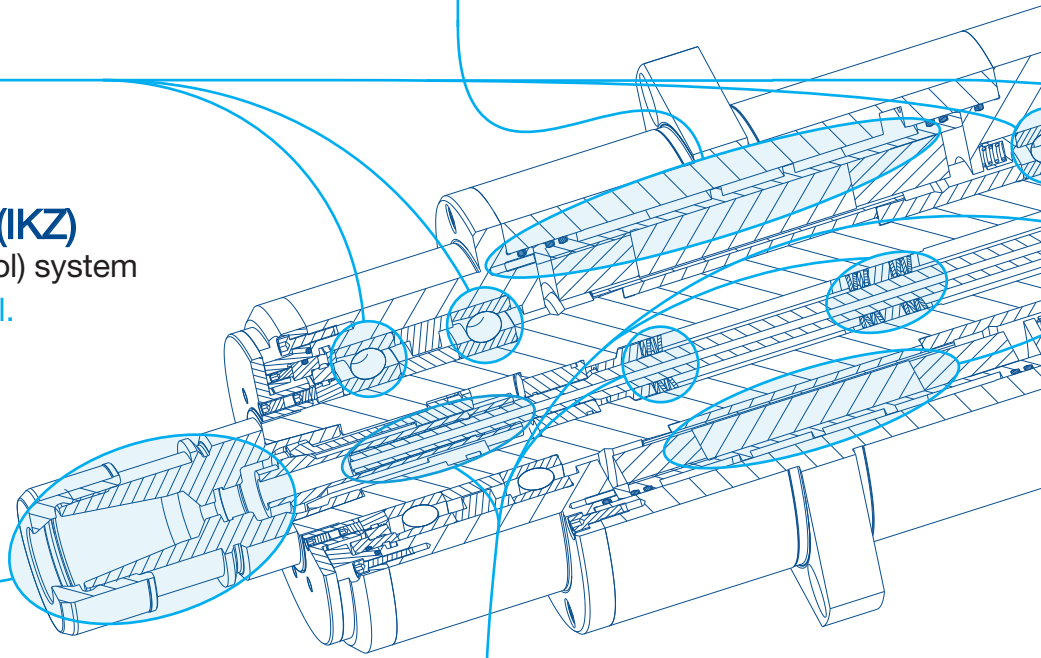

Drive system

AC / DC / Torque motors: our synchronous, asynchronous or torque motors are tailored according to specific characteristics and performances required by target application.

Belt driven system: Simple construction that permits the transmission of large torques in restricted overall dimensions.

Connecting orientation

- Axial

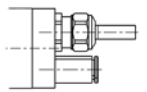

- Radial

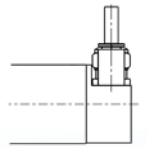

- Front

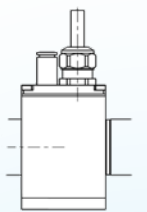

Release system

Pneumatic, hydraulic or by external action.

Peripheral devices

MEYRAT can advise and validate the choice of peripheral equipment, such as:

- Frequency converters
- Chiller
- Lubrication unit and oil
- Air filter
- Extension cables
- Rotary coupling
- ... and many others

Monitoring and data collection

For optimal driving during production cycle, MEYRAT spindles incorporate state-of-the-art control technology, such as:

- Bearings and motor temperature measurements
- Accelerometer (crash detection)
- Spindle nose expansion sensor (thermal)
- Analog / digital sensors (tool clamping)
- 1Vpp encoder (sin - cos)
- Acoustic Emissions Sensors (AE sensors)
- Monitoring of electrical current or apparent power
- ... and more depending on your requirements.

MEYRAT HIGH FREQUENCY

spindle range

- Up to 80'000 rpm
- Ø 16 - 80mm
- Low run-out: < 1 µm
- Excellent stiffness
- Ultra-high level of precision
- Efficient and high qualitative machining
- ATC-E15 - Automatic Tool Change

MHF













STANDARD
MHF

16 - 80 mm	40'000 - 80'000 rpm	Synchron	80 W to 3,8 kW	1,0 Ncm to 100 Ncm	SR6 ER8-UP ER11-UP HSK-E20 HSK-E25 ATC-E15 HSK-EZ15	Grease or Air-Oil	Excellent stiffness that gives your machining an ultra-high level of precision (< 1µm run-out).
------------	------------------------------	----------	----------------------	--------------------------	---	-------------------------	---

Exclusively developed and manufactured in Switzerland, our MHF (MEYRAT High Frequency) spindle range offers an efficient universal / micro machining with the highest precision and performance.

With plug-and-go equipment, the spindles are easy to install and require only minimal maintenance.

-  Diameter
-  Length (mm)
-  Connecting orientation
-  Motor type
-  RPM (min⁻¹)
-  Tool interface
-  Power (w)
-  Torque
-  Lubrication
-  Other
-  Article Nr

MHF-16

MEYRAT HIGH FREQUENCY SPINDLES

MHF-16 AXIAL 010-159-00

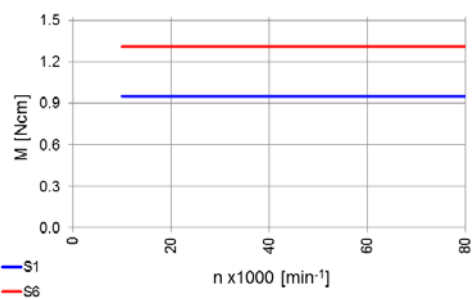
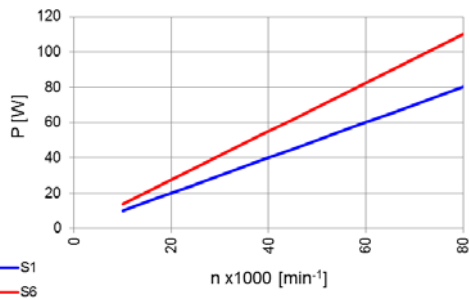
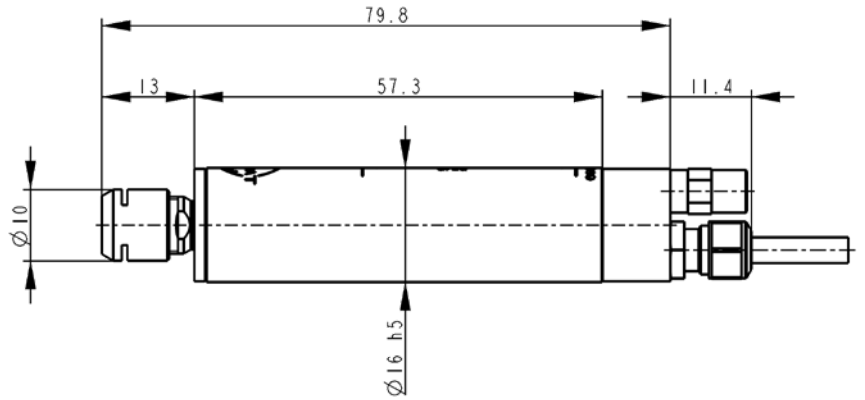

MHF-16 RADIAL 010-159-50

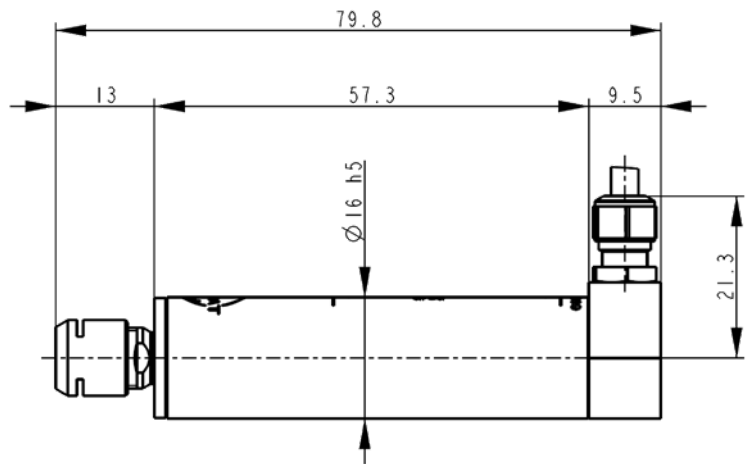

STANDARD MHF	16 mm	79.8 mm	Axial	Synchron	80'000 rpm	SR6	S1=80 W S6=110 W	S1=1.0 Ncm S6=1.3 Ncm	Grease	Air cooling	010-159-00
			Radial								010-159-50

MHF

MHF-19

MEYRAT HIGH FREQUENCY SPINDLES



MHF-19 AXIAL 010-158-00*

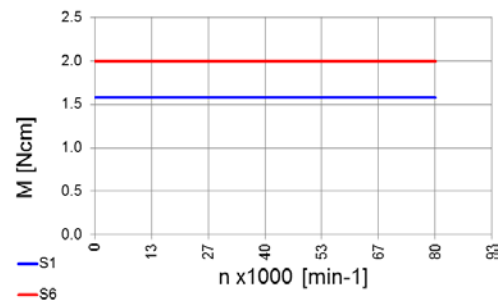
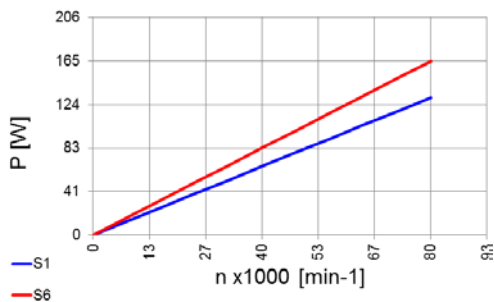
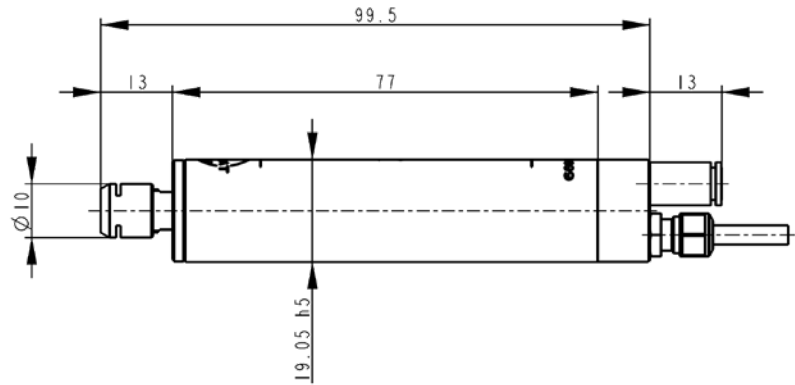

MHF-19 RADIAL 010-158-50

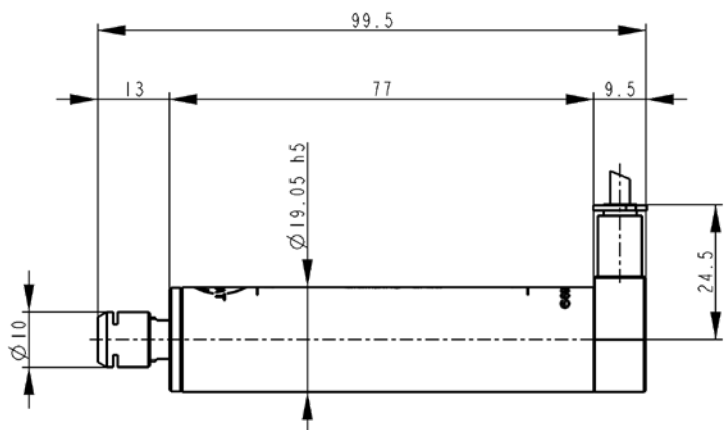

STANDARD MHF	19 mm	99.5 mm	Axial	Synchron	80'000 rpm	SR6	S1=135 W S6=165 W	S1=1.6 Ncm S6=2.0 Ncm	Grease	Air cooling	010-158-00
		86.5 mm	Radial								010-158-50
			Front								010-72-50

* Pictures of ETA6-UP version

MHF-20

MEYRAT HIGH FREQUENCY SPINDLES

MHF-20 AXIAL 010-163-00 as example

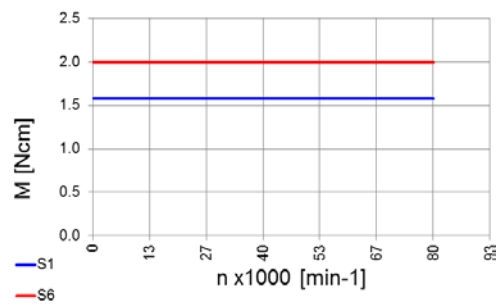
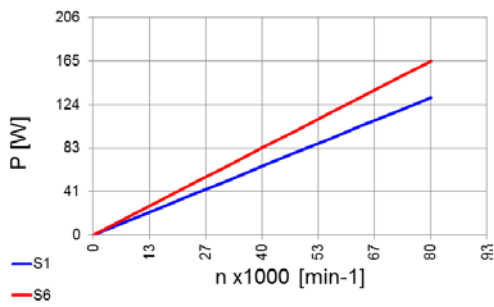
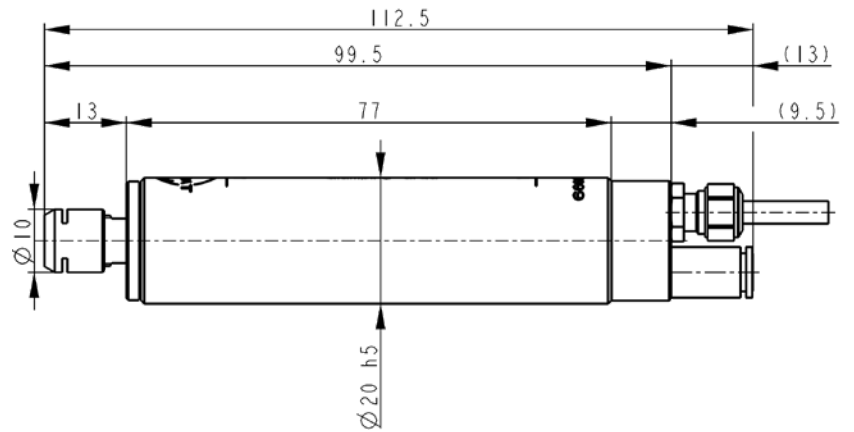

MHF-20 RADIAL 010-163-50 as example

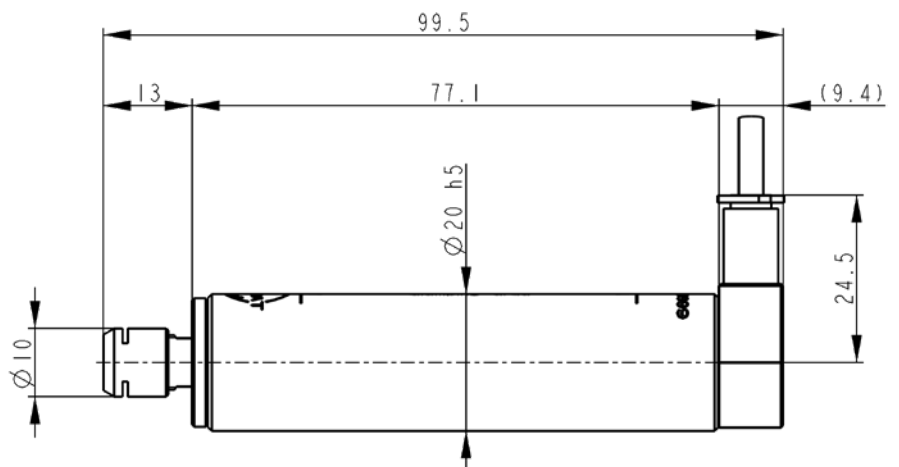

MHF-20

MEYRAT HIGH FREQUENCY SPINDLES



MHF-20
FRONT
010-71-50
as example

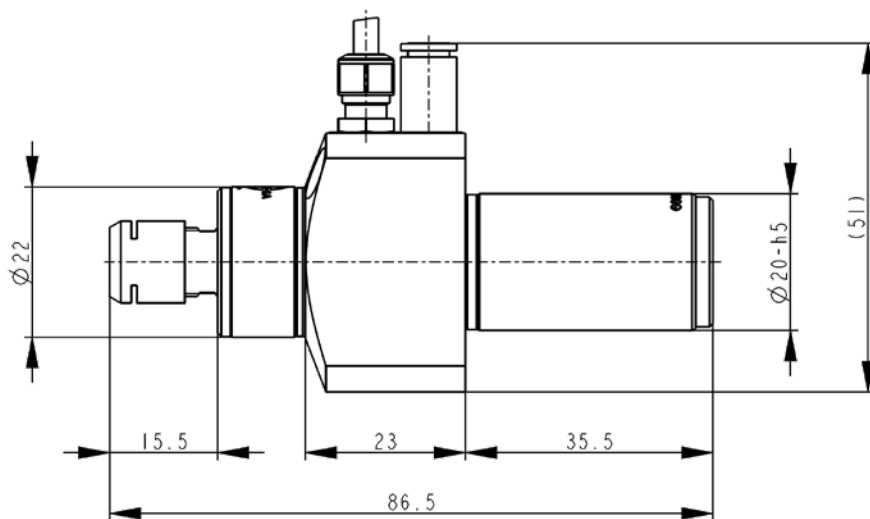
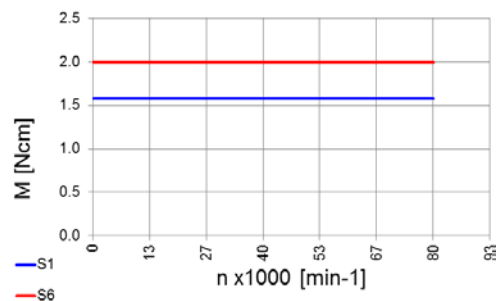
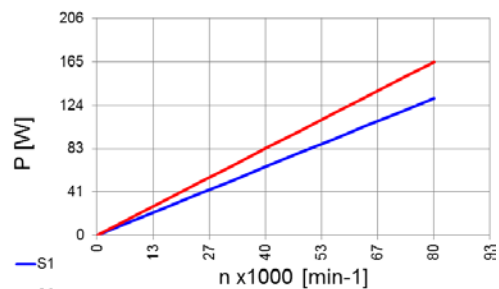

STANDARD MHF	20 mm	99.5 mm	Axial	Synchron	80'000 rpm	SR6	S1=135 W S6=165 W	S1=1.6 Ncm S6=2.0 Ncm	Grease	Air cooling	010-163-00
		86.5 mm	Radial								010-163-50
			Front								010-71-50

MHF

MHF-22

MEYRAT HIGH FREQUENCY SPINDLES

MHF-22
AXIAL
010-21-00
as example

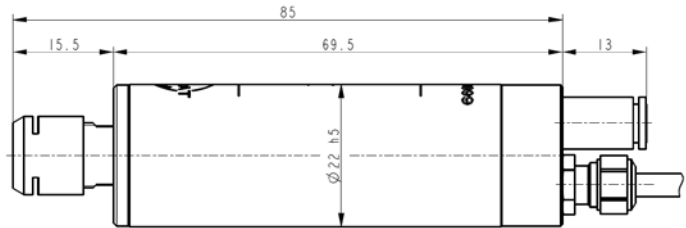

MHF-22
RADIAL
010-21-50
as example

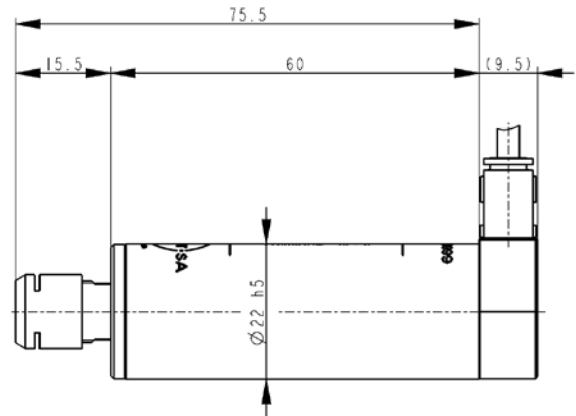

MHF-22
RADIAL
010-24-50
as example

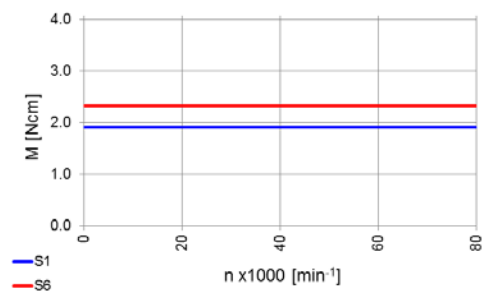
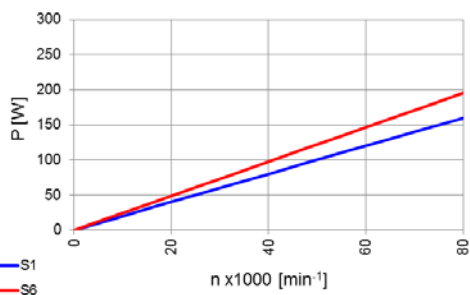
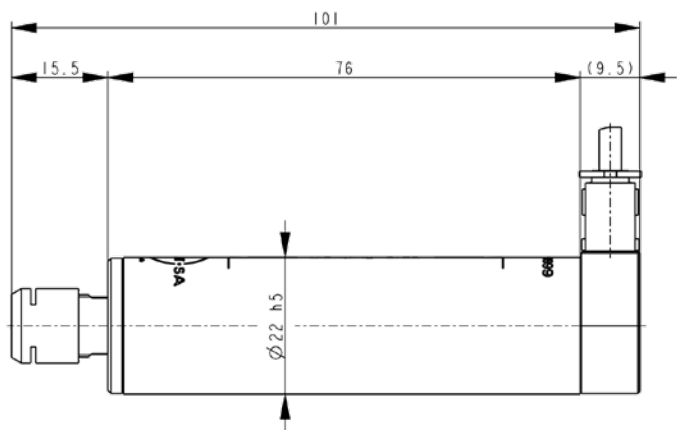

MHF

MHF-22

MEYRAT HIGH FREQUENCY SPINDLES



MHF-22
FRONT
010-101-50
as example

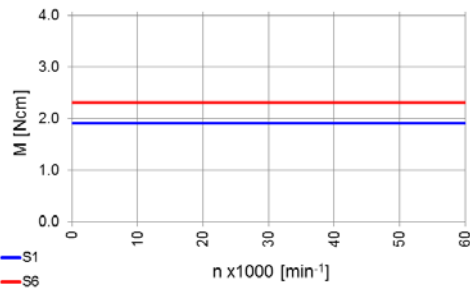
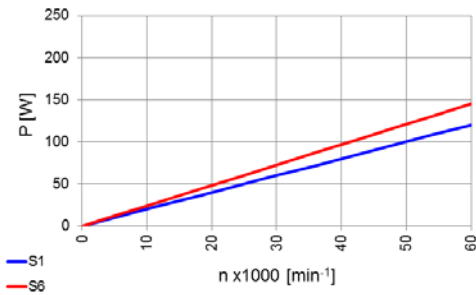
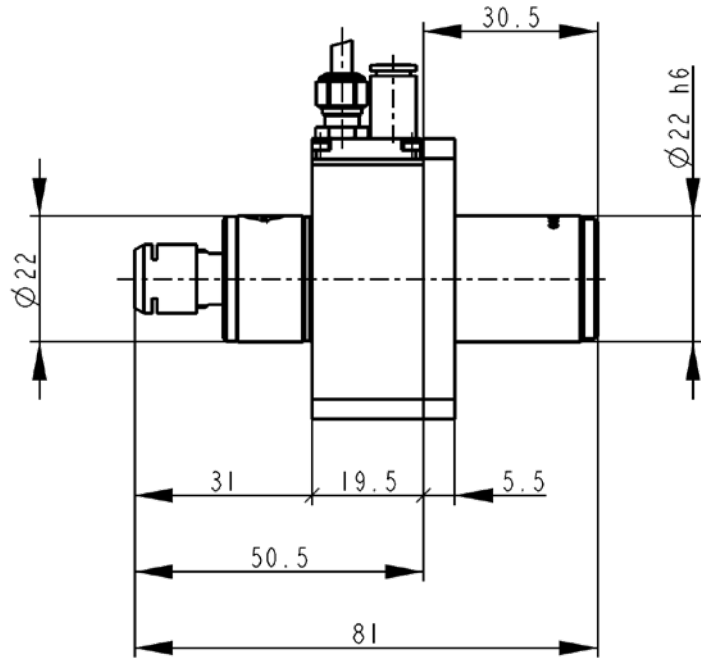

STANDARD MHF	22 mm	85 mm	Axial	Synchron	ER8-UP	Power		Cooling	Part No.				
						S1	S6						
						S1 = 120 W	S6 = 145 W	Grease	010-21-00				
						S1 = 160 W	S6 = 195 W	Air - Oil	010-22-00				
		101 mm	Radial			S1 = 120 W	S6 = 145 W	Grease	010-21-50				
						S1 = 160 W	S6 = 195 W	Air - Oil	010-22-50				
		101 mm	Axial	Synchron	ER8-UP	S1 = 120 W	S6 = 145 W	Air cooling	S1=1.9 Ncm	S6=2.3 Ncm	Grease	010-23-00	
													Air - Oil
			Radial							S1 = 120 W	S6 = 145 W	Grease	010-23-50
										S1 = 160 W	S6 = 195 W	Air - Oil	010-24-50
		81 mm	Front			S1 = 120 W	S6 = 145 W	Grease	010-101-50				

MHF

MHF-25

MEYRAT HIGH FREQUENCY SPINDLES

MHF-25 AXIAL 010-40-00 as example

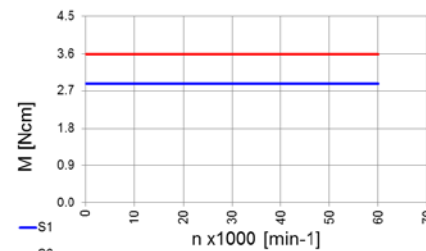
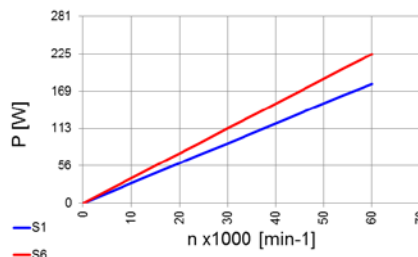
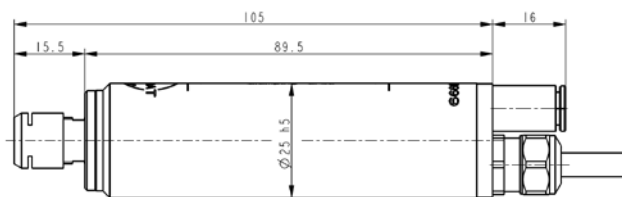

MHF-25 RADIAL 010-41-50 as example

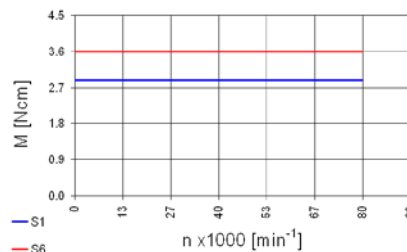
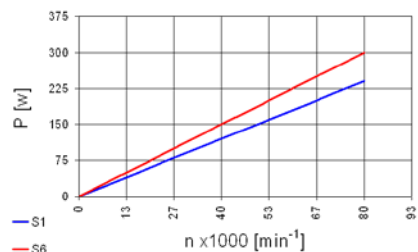
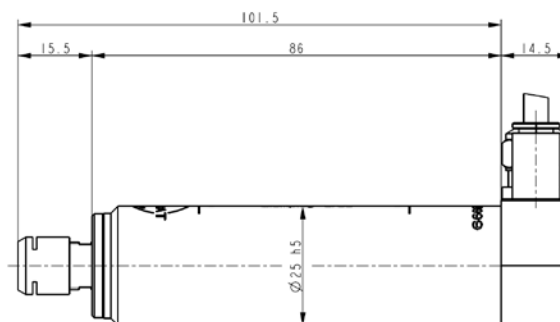

MHF

-
-
-
-
-
-
-
-
-
-
-

STANDARD MHF	25 mm	105 mm	Axial	Synchron	ER8-UP	S1=180 W	S6=225 W	S1=2.9 Ncm	S6=3.6 Ncm	Grease	Air cooling	010-40-00
						S1=240 W	S6=300 W					010-41-00
		116 mm	Radial	Synchron	ER8-UP	S1=180 W	S6=225 W	S1=2.9 Ncm	S6=3.6 Ncm	Grease	Air cooling	010-40-50
						S1=240 W	S6=300 W					010-41-50
		137 mm	Axial	Synchron	ER8-UP	S1=180 W	S6=225 W	S1=2.9 Ncm	S6=3.6 Ncm	Grease	Air cooling	010-42-00
						S1=240 W	S6=300 W					010-43-00
		148 mm	Radial	Synchron	ER8-UP	S1=180 W	S6=225 W	S1=2.9 Ncm	S6=3.6 Ncm	Grease	Air cooling	010-42-50
						S1=240 W	S6=300 W					010-43-50

MHF-30

MEYRAT HIGH FREQUENCY SPINDLES



MHF-30 AXIAL

010-112-00
as example

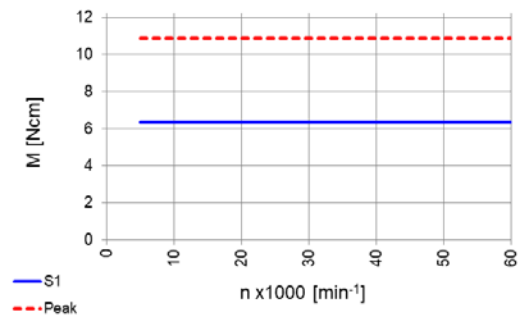
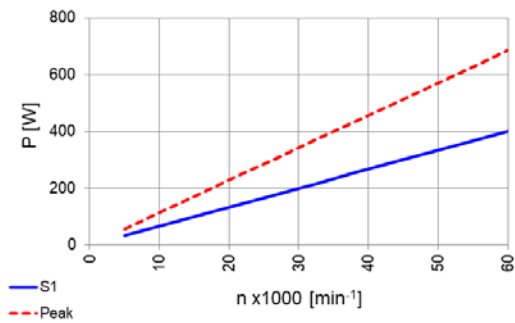
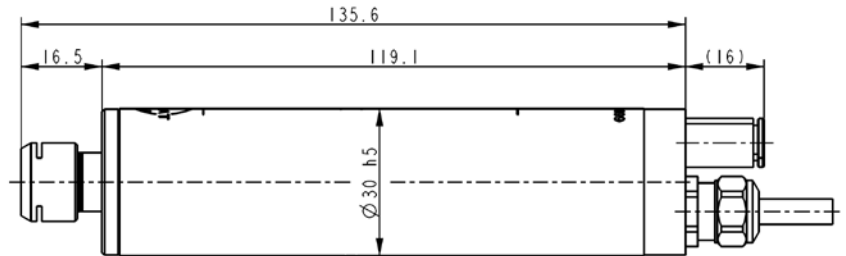

MHF-30 RADIAL

010-112-50
as example

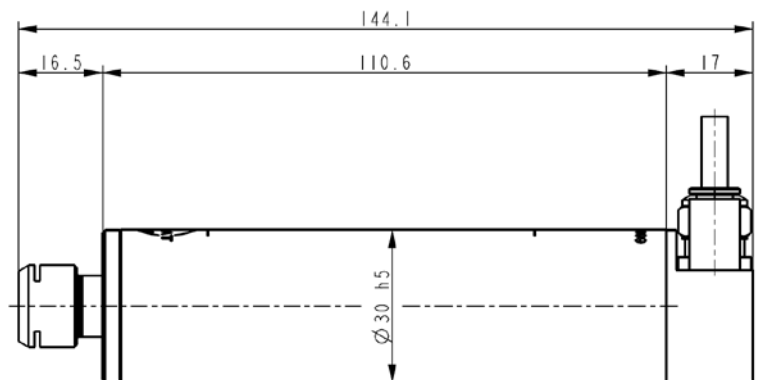

STANDARD MHF	30 mm	135.6 mm	Axial	Synchron	ER11-UP	S1=400 W S6=500 W		S1=6.4 Ncm S6=7.3 Ncm	Grease	Air cooling	010-112-00	
						S1=535 W S6=670 W					Air - Oil	010-113-00
						S1=400 W S6=500 W					Grease	010-112-50
						S1=535 W S6=670 W					Air - Oil	010-113-50
		144.1 mm	Radial									

MHF-35 ATC

MEYRAT HIGH FREQUENCY SPINDLES

MHF-35 ATC

AXIAL

010-146-00

as example

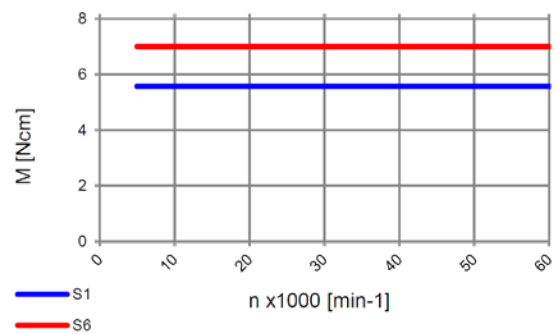
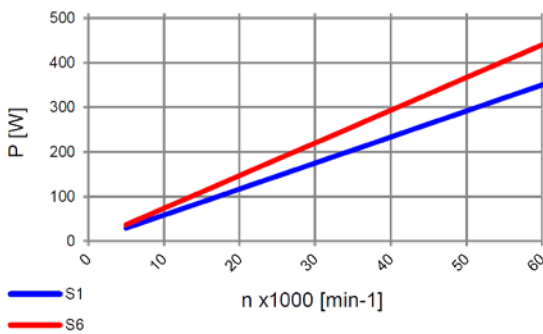
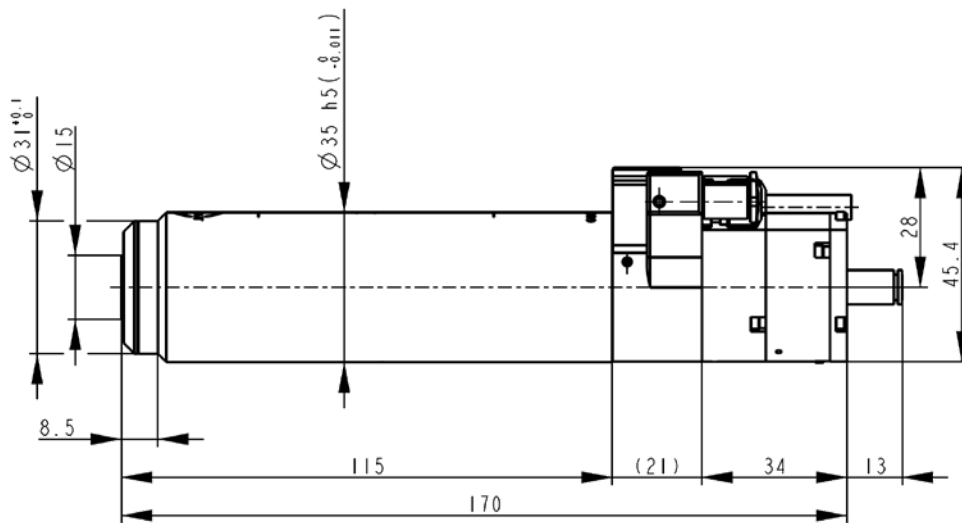

STANDARD MHF	35 mm	170 mm	Axial	Synchron	60'000 rpm	ATC-E15 HSK-EZ15	S1=350 W S6=440 W	S1=5.6 Ncm S6=7.0 Ncm	Grease	5 bar* Tool Clamping Control Air cooling	010-146-00
	* pneumatic release unit										

* pneumatic release unit

MHF

MHF-45 ATC

MEYRAT HIGH FREQUENCY SPINDLES



**MHF-45
AXIAL**
010-137-00
as example

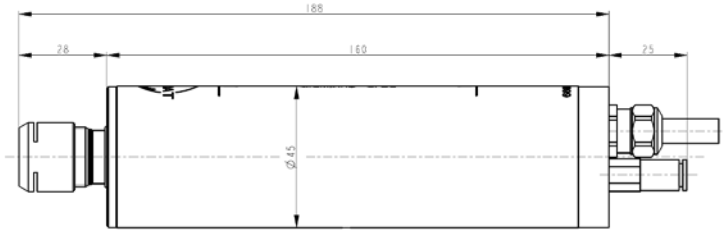

**MHF-45
RADIAL**
010-137-50
as example



**MHF-45
RADIAL**
010-140-50
as example

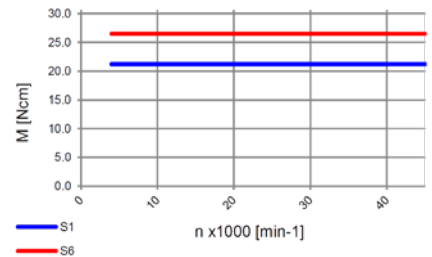
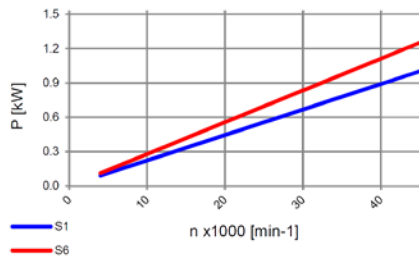
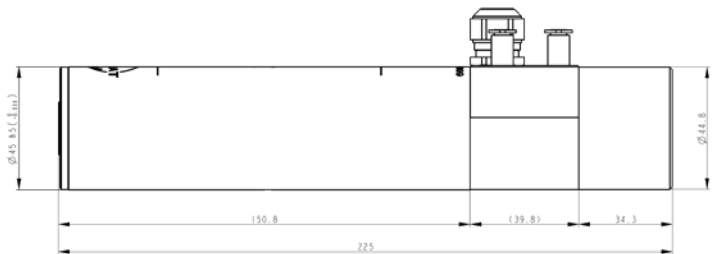

MHF



STANDARD MHF	45 mm	188 mm	Axial	Synchron	45'000 rpm	ER16	S1=1000 W S1=21.2 Ncm S6=1300 W S6=26.5 Ncm	Grease	Air cooling	010-137-00
		198 mm	Radial						Air cooling	010-137-50
		225 mm	Radial						Air cooling 5 bar* Tool Clamping Control	010-140-50
						HSK-E20 ATC				

* pneumatic release unit

MHF-80

MEYRAT HIGH FREQUENCY SPINDLES

MHF-80
AXIAL
010-141-00
as example

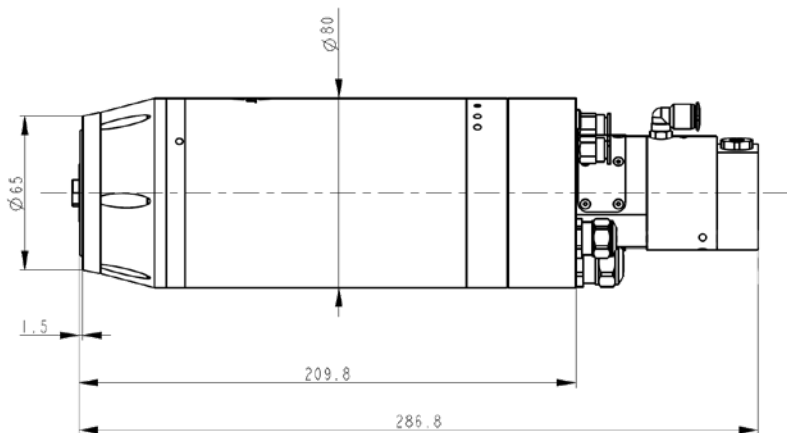

MHF-80
AXIAL
010-144-00
as example

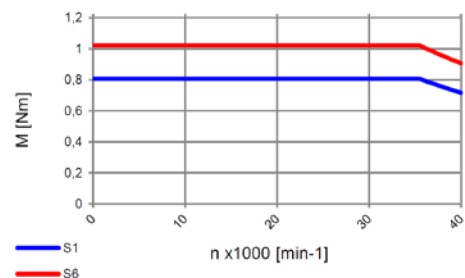
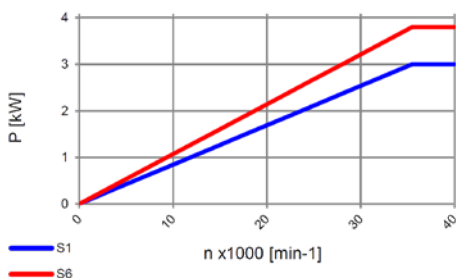
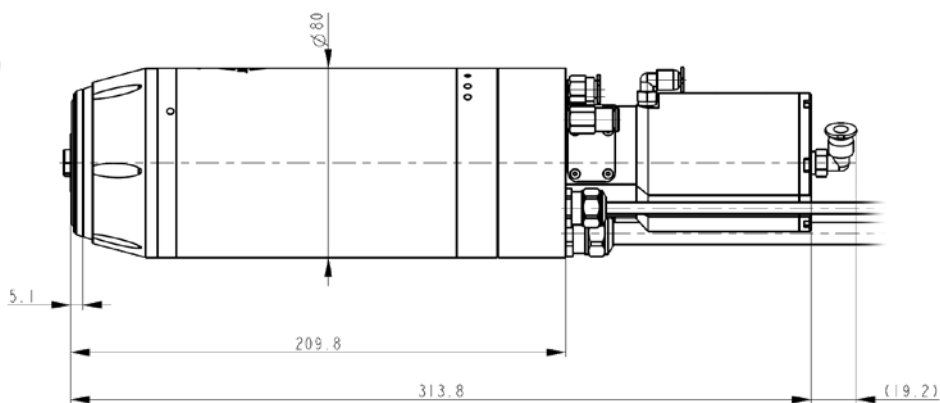

AVAILABLE
OPTIONS

Encoder
Pneumatic cylinders
Bearing temperature sensors
Rotary joint



STANDARD MHF	80 mm	286.8 mm	Axial	Synchron	40'000 rpm	HSK-E25	S1=3 KW	S1=80 Ncm	Grease	Water cooling	010-141-00
		313.8 mm			60'000 rpm		S6=3.8 KW	S6=100 Ncm			Air - Oil

PEOPLE.



PASSION.



MHF

PRECISION.



MEYRAT HIGH TORQUE

spindle range

- High torque
- Ø 25 - 45mm
- 6 to 70Ncm
- Up to 40'000 rpm
- ER Clamp
- ATC-E15 - Automatic Tool Change
- Same compact design as corresponding MHF spindles

MHT











STANDARD
MHT



25 - 45 mm	20'000 - 40'000 rpm	Synchron	240 W to 1,6 kW	5,7 Ncm to 70 Ncm	ER8-UP ER11-UP ER16-UP HSK-E20 ATC-E15 HSK-EZ15	Grease or Air-Oil	High torque for high performances (3 to 4x more torque compared to MHF of the same Ø). Also with through-spindle/tool coolant (IKZ).
------------	------------------------------	----------	-----------------------	-------------------------	--	-------------------------	--

Exclusively developed and manufactured in Switzerland, our MHT (MEYRAT High Torque) spindle range is built for challenging applications requiring high torque in confined spaces, and allows a higher productivity and a perfect surface finish.

Ideal for universal applications such as cutting, dressing, drilling, etching, forming, grinding, milling, swiss lathing, turning, etc.

-  Diameter
-  Length (mm)
-  Connecting orientation
-  Motor type
-  RPM (min⁻¹)
-  Tool interface
-  Power (w)
-  Torque
-  Lubrication
-  Other
-  Article Nr

MHT-25

MEYRAT HIGH TORQUE SPINDLES

MHT-25
AXIAL
010-44-00
as example

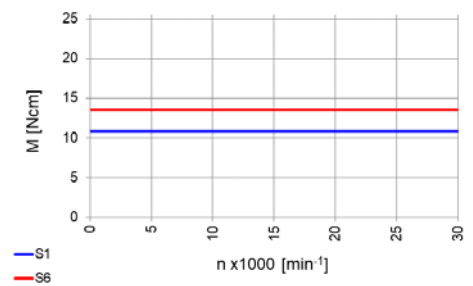
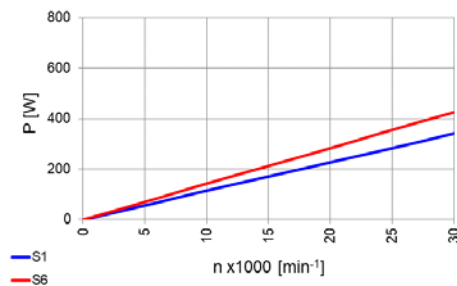
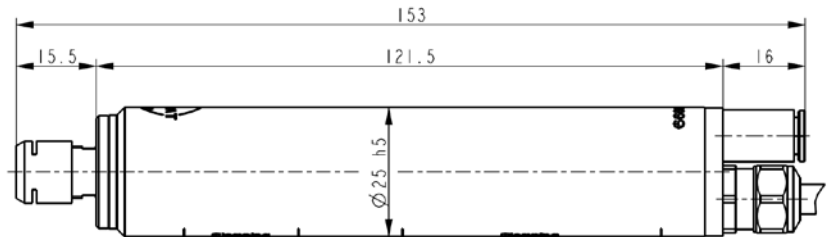

MHT-25
RADIAL
010-44-50
as example

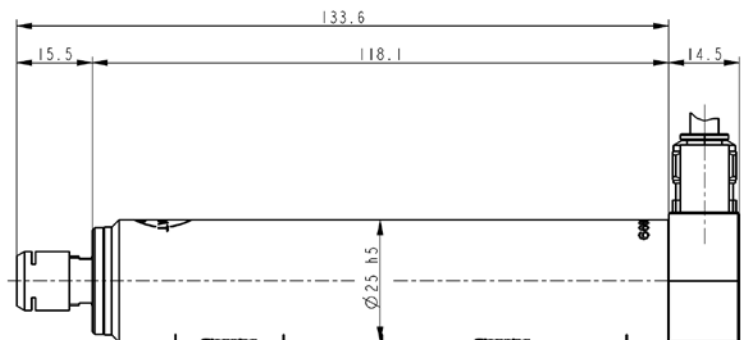

STANDARD MHT	25 mm	137 mm	Axial	Synchron	30'000 rpm	ER8-UP	S1=340 W S6=425 W	S1=10.8 Ncm S6=13.5 Ncm	Grease	Air cooling	010-44-00
									Air - Oil		010-45-00
		133.6 mm	Radial						Grease		010-44-50
									Air - Oil		010-45-50

MHT-30

MEYRAT HIGH TORQUE SPINDLES



MHT-30 AXIAL 010-74-00 as example

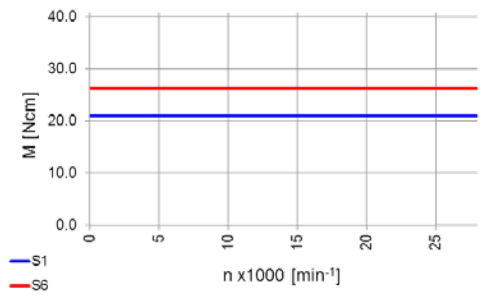
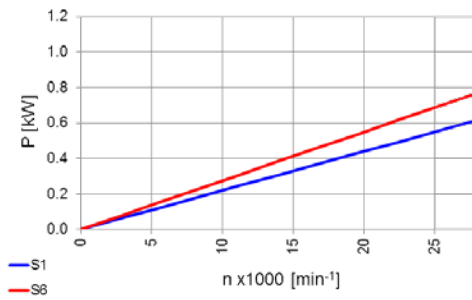
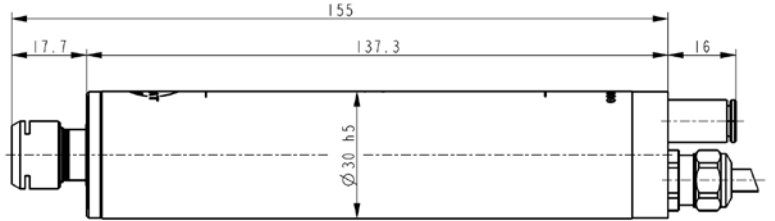

MHT-30 RADIAL 010-75-50 as example

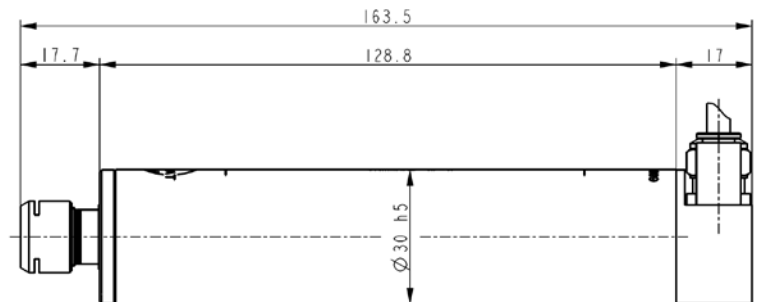

STANDARD MHT	30 mm	155 mm	Axial	Synchron	28'000 rpm	ER11-UP	S1=615 W S6=770 W	S1=21.0 Ncm S6=26.3 Ncm	Grease	Air cooling	010-74-00
		146.5 mm	Radial						Air - Oil		010-75-00
	Grease								010-74-50		
	Air - Oil	010-75-50									

MHT

MHT-30 IKZ

MEYRAT HIGH TORQUE SPINDLES

MHT-30 IKZ

AXIAL

010-77-00
as example



Through-spindle coolant (IKZ)

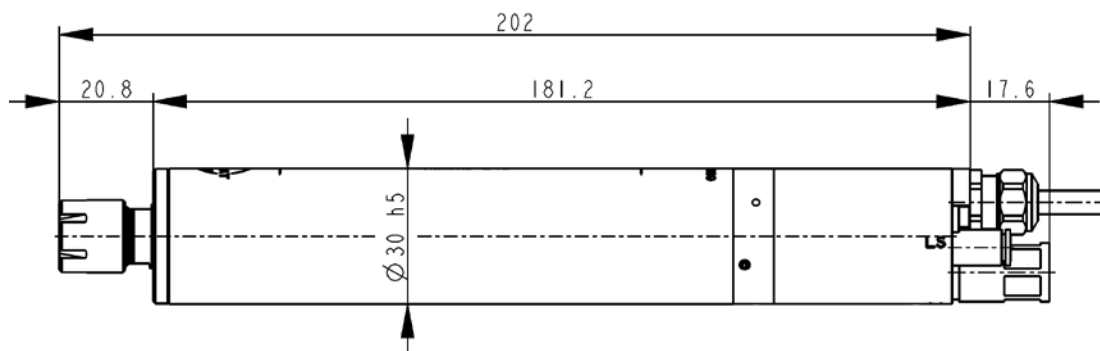
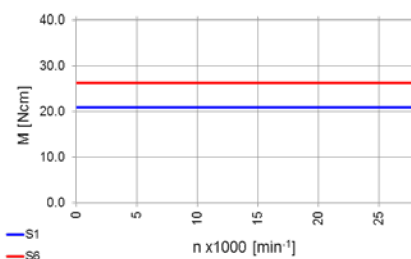
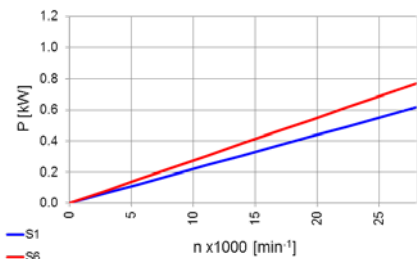

STANDARD MHT	30 mm	202 mm	Axial	Synchron	28'000 rpm	ER11-UP	S1=615 W S6=770 W	S1=21.0 Ncm S6=26.3 Ncm	Grease	Through-spindle coolant (IKZ)	010-76-00
									Air - Oil		010-77-00

MHT



MHT-30 ATC

MEYRAT HIGH TORQUE SPINDLES



“Faster and more precise tool change with our ATC-System!”

MHT-30 ATC-E15

RADIAL

010-102-50
as example

Booster for MHT-30 ATC-E15
010-102-50 / 010-103-50

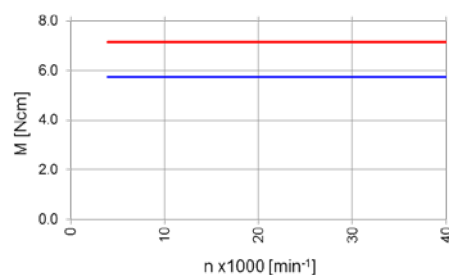
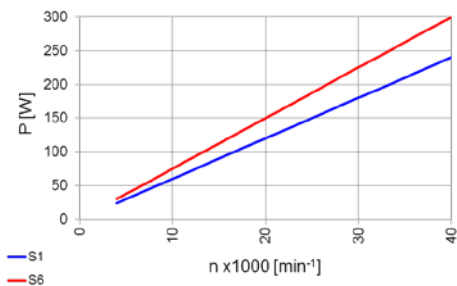
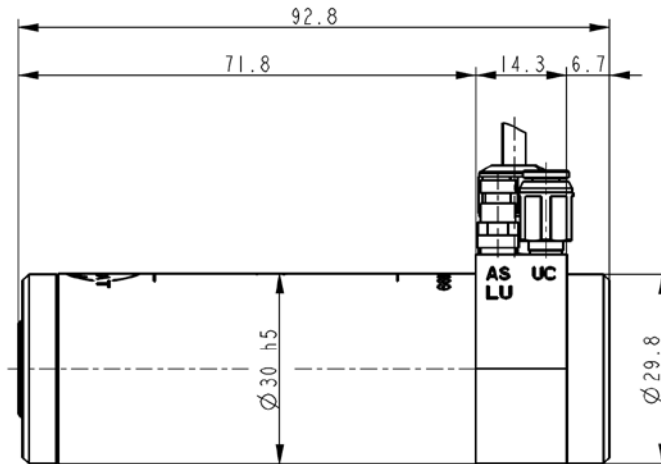

STANDARD MHT	30 mm	92.8 mm	Radial	Synchron	40'000 rpm	ATC-E15 HSK-EZ15	S1=240 W S6=300 W	S1=5.7 Ncm S6=7.2 Ncm	Grease	12 bar* Tool Clamping Control	010-102-50
									Air - Oil	Air cooling	010-103-50

* pneumatic release unit

MHT

MHT-30 ATC

MEYRAT HIGH TORQUE SPINDLES

MHT-30 ATC-E15

AXIAL
010-133-00
as example

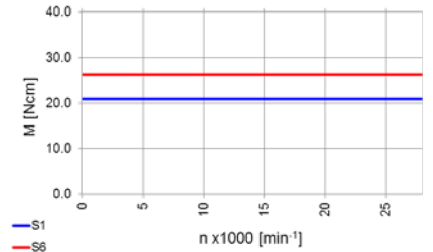
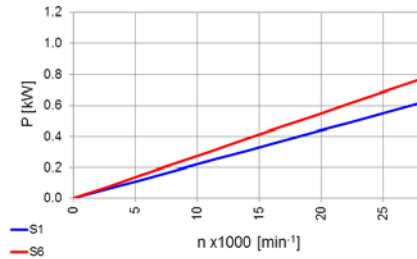
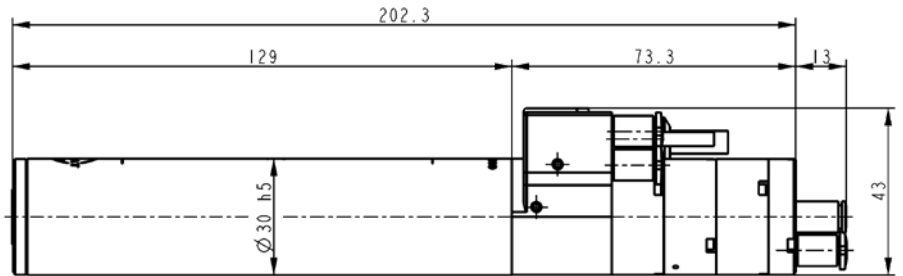

MHT-30 ATC-E15

RADIAL
010-133-50
as example

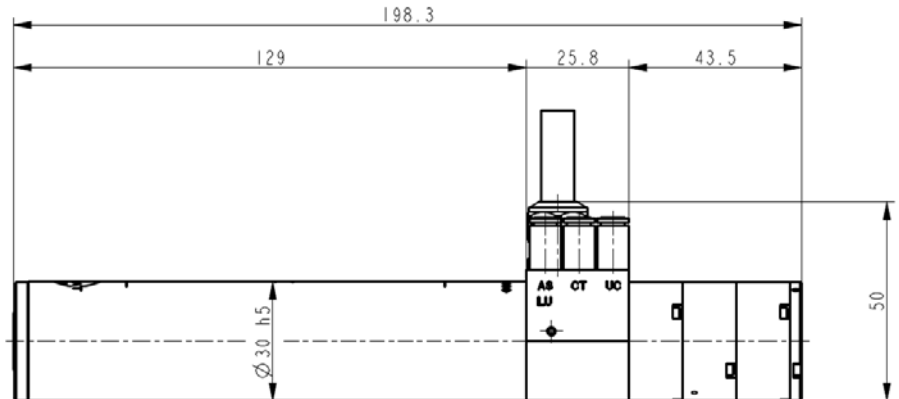

STANDARD MHT	30 mm	198.3 mm	Radial	Synchron	28'000 rpm	ATC-E15 HSK-EZ15	S1=615 W S6=770 W	S1=21 Ncm S6=26.3 Ncm	Grease	5 bar* Tool Clamping Control	010-133-50
		202.3 mm	Axial						Air - Oil		010-134-50
	Grease			Air cooling	010-133-00						
	Air - Oil	010-134-00									

* pneumatic release unit

MHT-45 ATC

MEYRAT HIGH TORQUE SPINDLES



**MHT-45
AXIAL**
010-136-00
as example

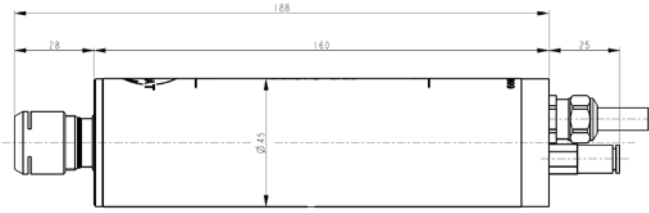

**MHT-45
RADIAL**
010-136-50
as example

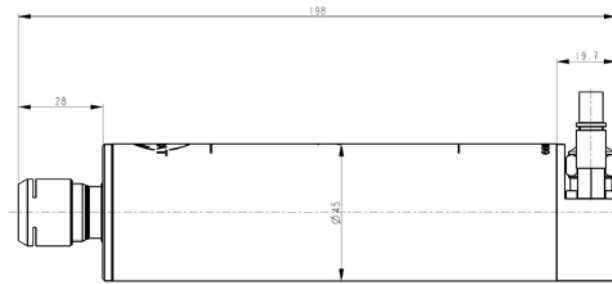

**MHT-45
RADIAL**
010-139-50
as example

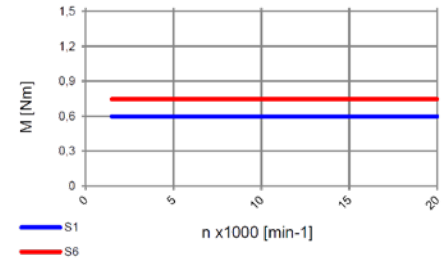
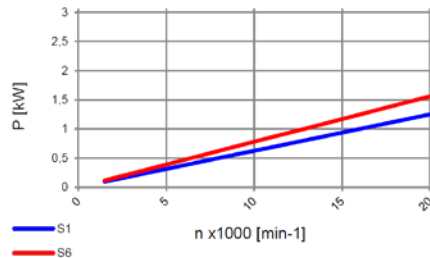
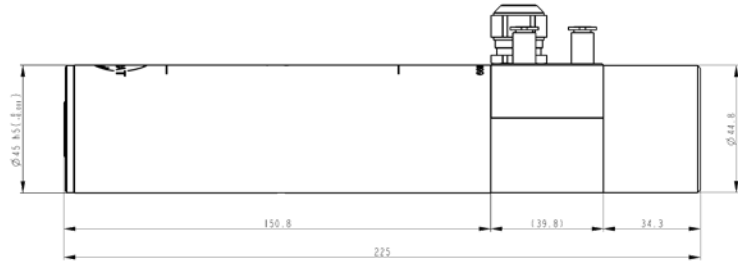

-
-
-
-
-
-
-
-
-
-

STANDARD MHT	45 mm	188 mm	Axial	Synchron	20'000 rpm	ER16	S1=1300 W S6=1600 W	S1=60 Ncm S6=70 Ncm	Grease	Air cooling	010-136-00
		198 mm	Radial								010-136-50
		225 mm								Air cooling 5 bar* Tool Clamping Control	010-139-50

* pneumatic release unit

MHT

MEYRAT DRESSING

spindle range

- **Ø 38 - 78mm**
- **Minimal maintenance because of lifetime greased bearings**
- **Greatly simplified integration and installation due to air cooling**
- **High torque and high performance**
- **Conceptual high rigidity**

MDS













STANDARD
MDS

38 - 78 mm	6'000 - 25'000 rpm	Synchron	150 W to 2,4 kW	5,7 Ncm to 3,3 Nm	Ø8 h4 Ø20 h3 Ø35 h3 Ø40 h3	Grease	Available with asynchronous or synchronous motor with very high torque and up to 25,000 rpm. Optionally, the spindles can be equipped with AE sensor. This makes the MDS spindle family the ideal tool for dressing and grinding.
------------	-----------------------------	----------	-----------------------	-------------------------	-------------------------------------	--------	---

Exclusively developed and manufactured in Switzerland, our well-structured MDS (MEYRAT Dressing Spindle) range includes the perfect combination of technology and characteristics for high-precision dressing and grinding applications.

The spindles can optionally be equipped with Acoustic Emission sensors (AE sensors).

-  Diameter
-  Length (mm)
-  Connecting orientation
-  Motor type
-  RPM (min⁻¹)
-  Tool interface
-  Power (w)
-  Torque
-  Lubrication
-  Other
-  Article Nr

MDS-38

MEYRAT DRESSING SPINDLES

MDS-38
RADIAL
718-01-00
as example

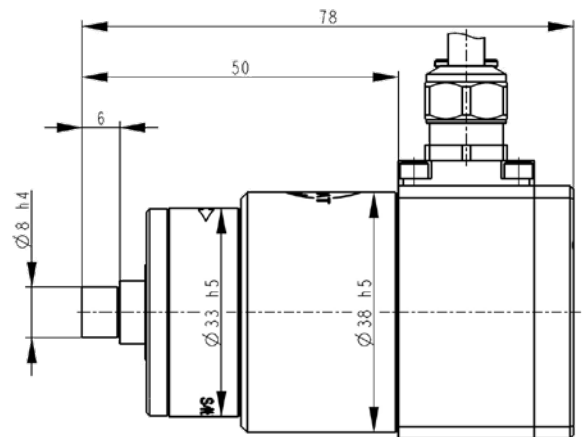
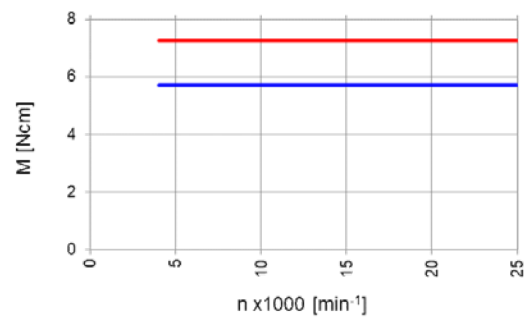
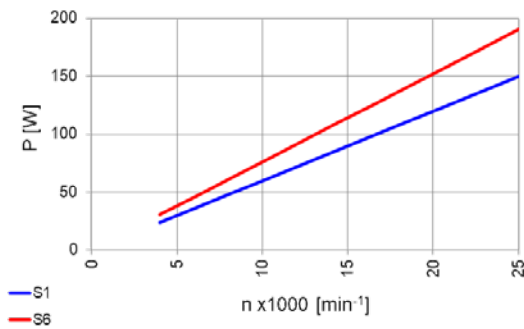
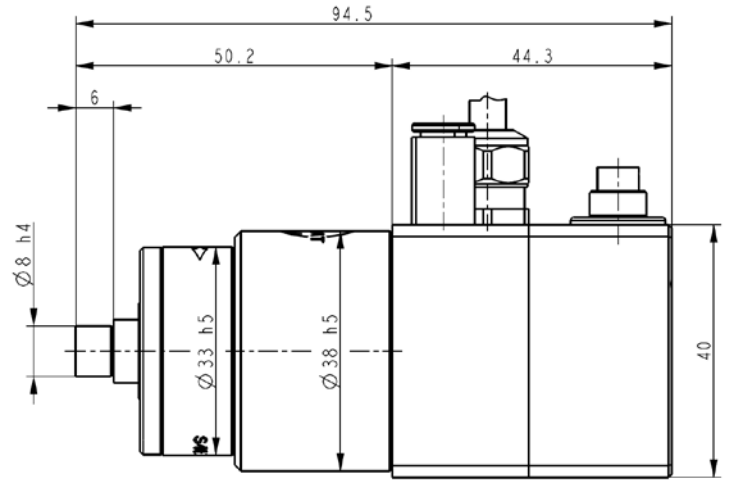
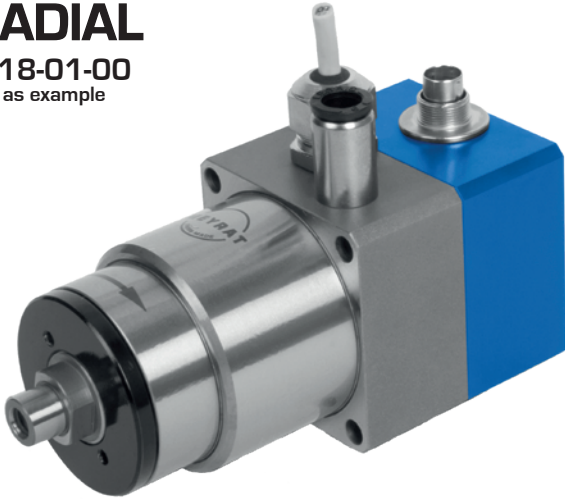

STANDARD MDS	38 mm	78 mm	Radial	Synchron	25'000 rpm	Ø8 h4	S1=150 W S6=190 W	S1=5.7 Ncm S6=7.3 Ncm	Grease	Air cooling	718-08-00
		94.5 mm								AE*-Sensor Elaso	718-01-00

*acoustic emission

MDS

MDS-58

MEYRAT DRESSING SPINDLES



MDS-58
RADIAL
173-37-00
as example

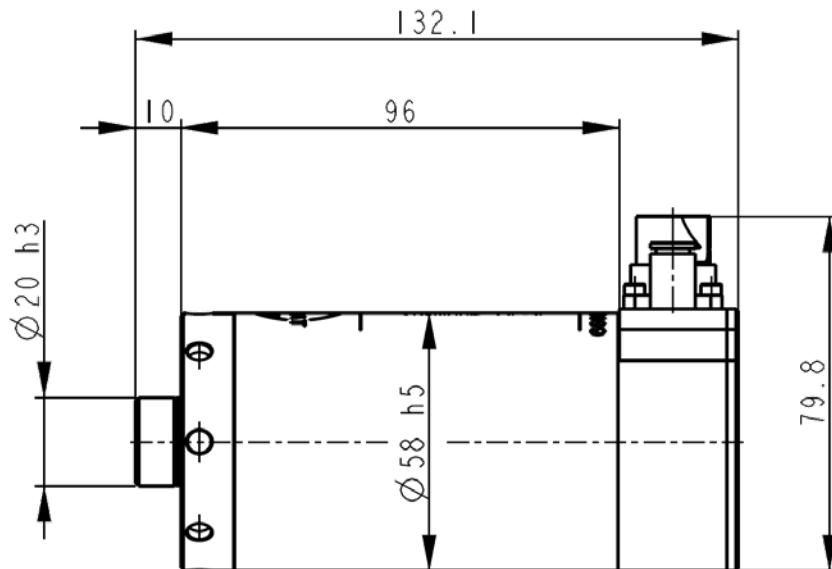
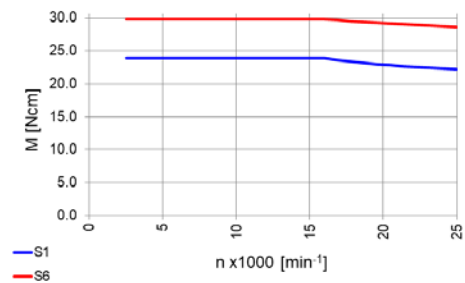
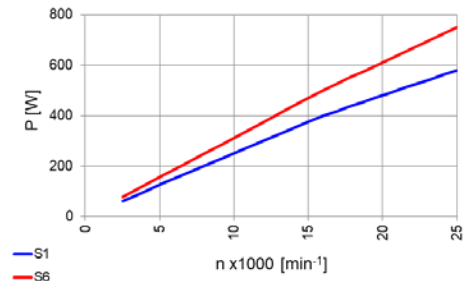

STANDARD MDS	58 mm	Radial	Synchron	25'000 rpm	$\varnothing 20$ h3	S1=580 W S6=750 W	S1=23.9 Ncm S6=29.8 Ncm	Grease	Air cooling	173-37-00
									AE-Sensor Dittel Marposs	173-33-00
									Air cooling AE-Sensor Elaso	173-36-00
									Air cooling AE-Sensor SBS	173-34-00
									Air cooling	

MDS

MDS-72

MEYRAT DRESSING SPINDLES

MDS-72
RADIAL
718-03-00
(Elaso AE Sensor)
as example

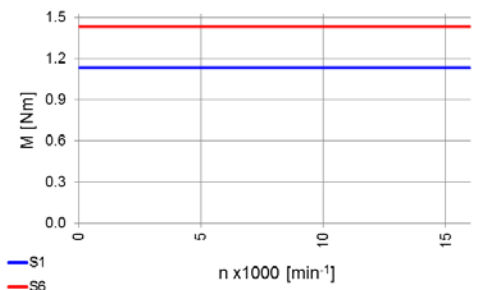
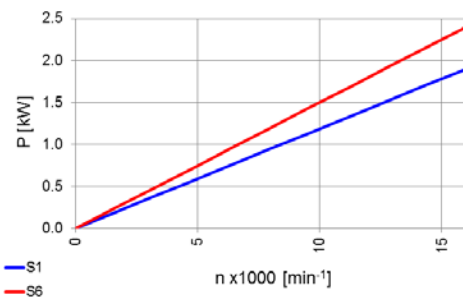
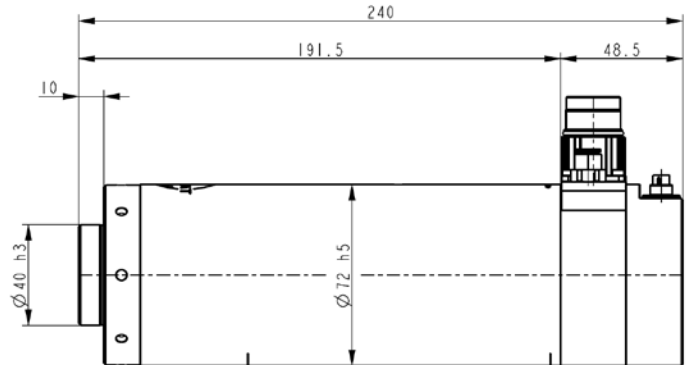

MDS-72
RADIAL
718-50-00
as example

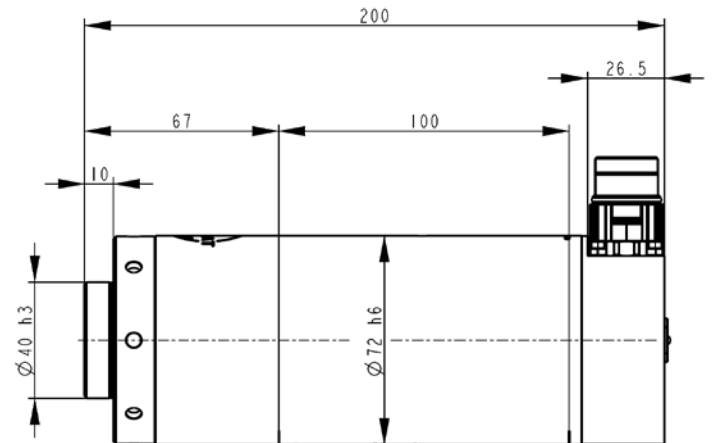

STANDARD MDS	72 mm	Radial	Synchron	Ø40 h3	16'000 rpm		Grease	PERFORMANCE	
					S1=2.6 KW	S1=1.8 Nm		Air cooling	718-05-00
					S6=3.2 KW	S6=2.1 Nm		AE-Sensor Elaso, SBS or Dittel*/Air cool.	718-03-00 718-25-00 718-06-00
								Air cooling	718-50-00
					8'000 rpm			STANDARD	
					S1=1.4 KW	S1=1.6 Nm		AE-Sensor Elaso Greenline, Balance Systems Dittel*Blü /Air cool.	
					S6=1.8 KW	S6=2.1 Nm		718-60-00 718-33-00 718-39-00	

*DITTEL MARPOSS

MDS

MDS-76/78

MEYRAT DRESSING SPINDLES



MDS-76 RADIAL

718-18-00
as example

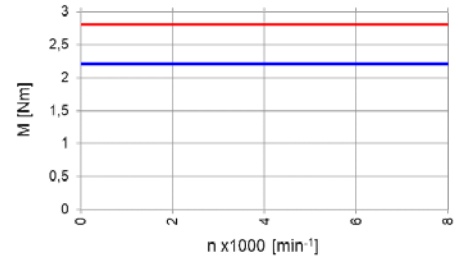
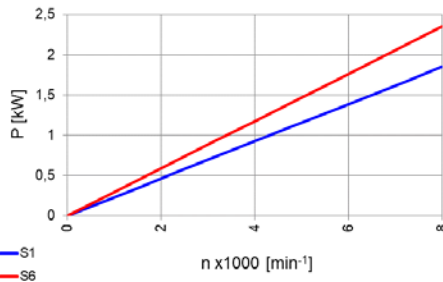
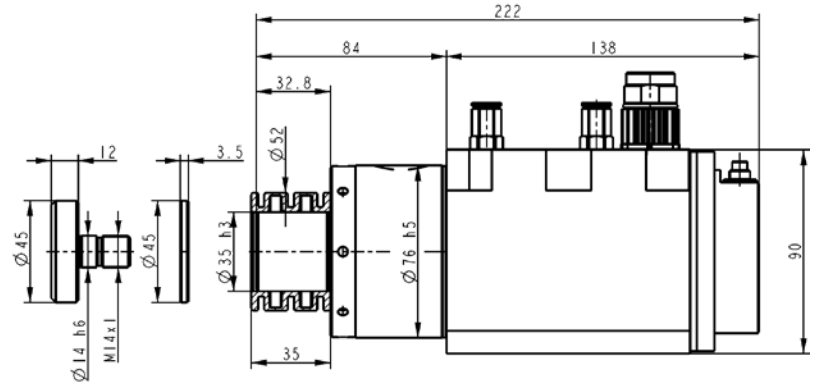

MDS-78 RADIAL

718-19-00
as example

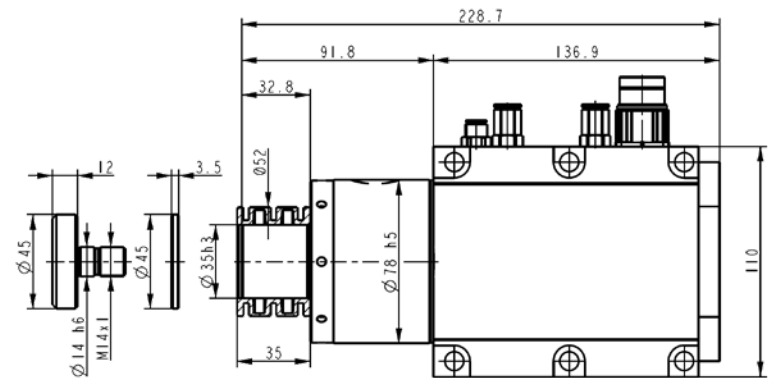

STANDARD MDS	76 mm	203.5 mm	Radial	Synchron	8'000 rpm	Ø35 h3	S1=1850 W S6=2135 W	S1=2.2 Nm S6=2.6 Nm	Grease	Water cooling	718-22-00
		222 mm								AE-Sensor Elaso Water cooling	718-18-00
	78 mm	228.7 mm	6'000 rpm	S1=1700 W S6=2100 W	S1=2.7 Nm S6=3.3 Nm	Water cooling	718-19-00				
		247.2 mm		AE-Sensor Elaso Water cooling	718-13-00						

MDS

MEYRAT standard spindle system

(exempt ATC)

All the **MEYRAT standard spindle ranges** compehence a specifically developed accessories kit that gives you the value add:

- Best performance for your applications
- Optimal control
- Easy and quick installation (plug-and-go)

CLAMPING SYSTEM

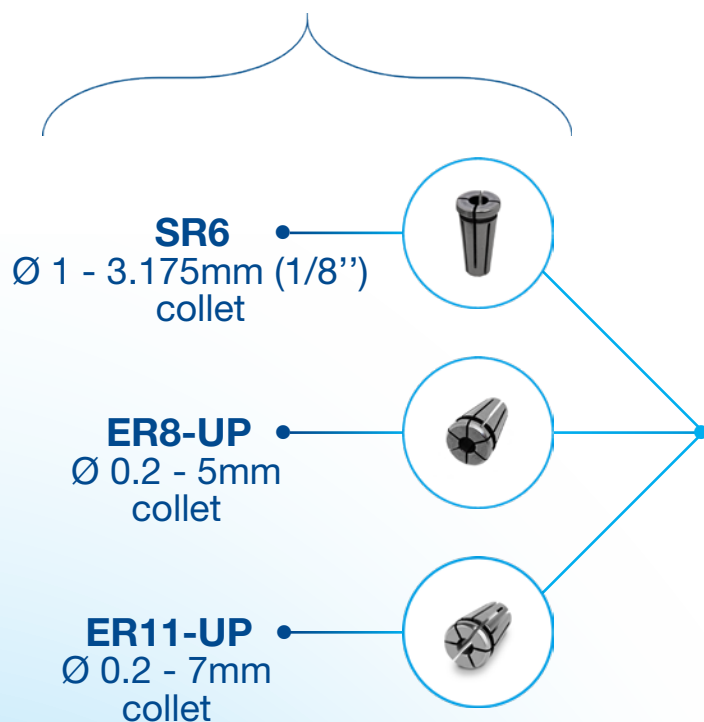

SPINDLES

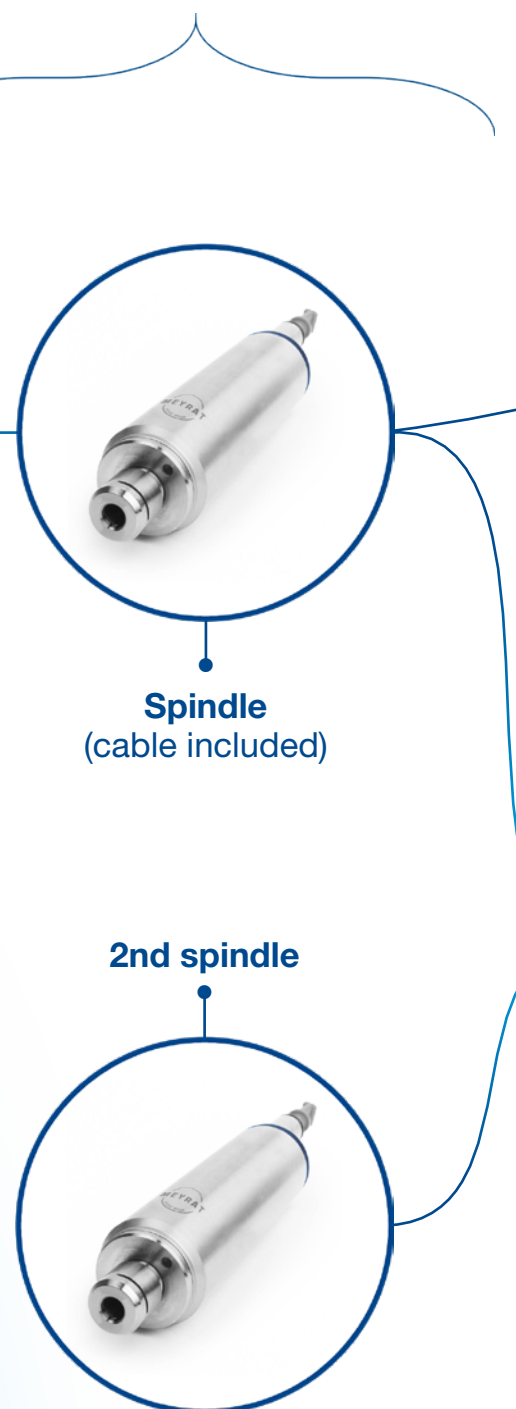

POWER SUPPLY

COMPRESSED AIR SUPPLY

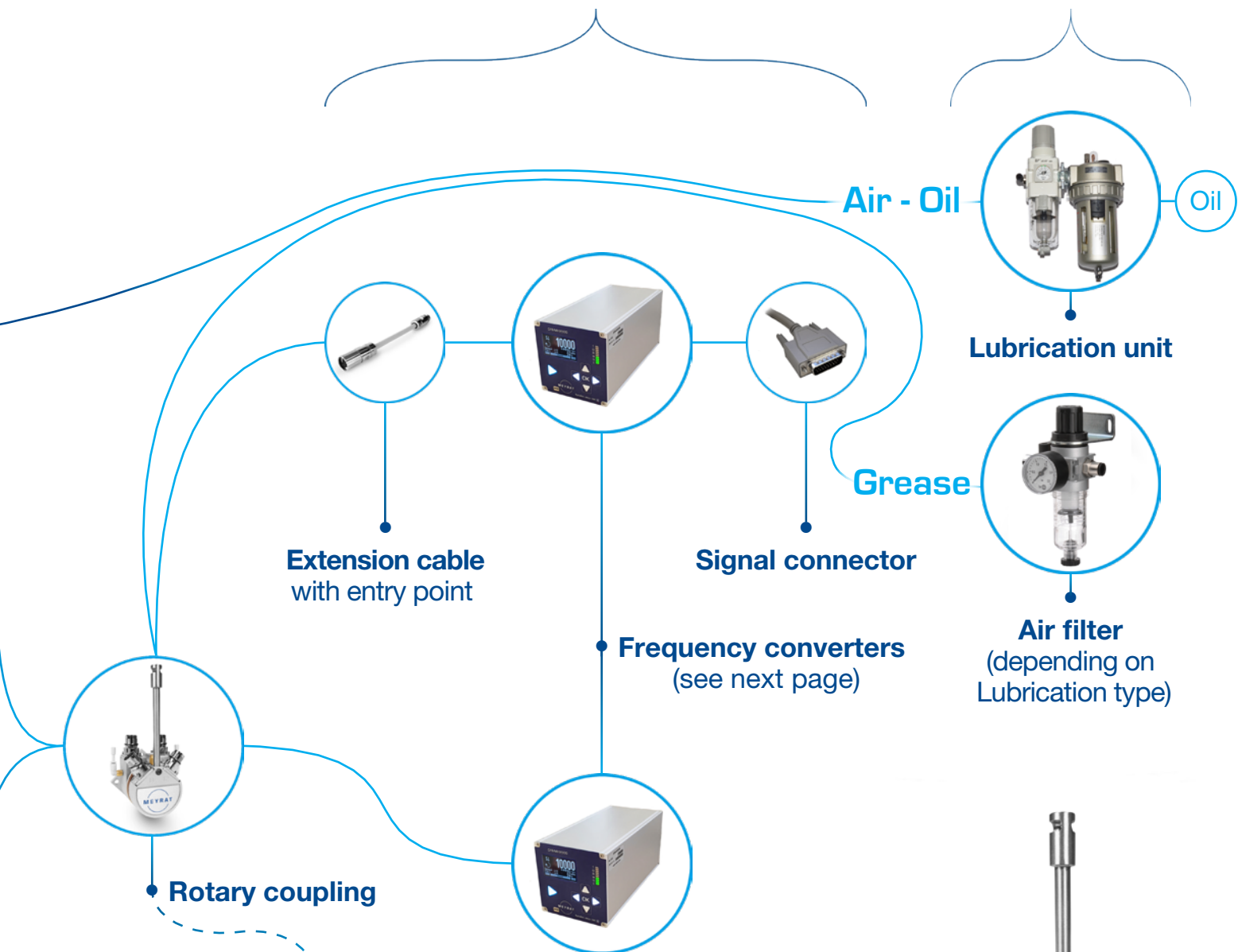

Coupler

MEYRAT Rotary coupling Typ JTE-RC-2MM

- Cable management: the cable system is free of tension made by spindle rotations.
- Allows to connect 2 grease lubricated spindles to the same coupler.



MEYRAT ATC spindle system

The **MEYRAT ATC spindle range** also compehence a specifically developed accessories kit that gives you the value add:

- Best performance for your applications
- Optimal control
- Easy and quick installation (plug-and-go)
- Quick and precise tool change

CLAMPING SYSTEM

SPINDLE

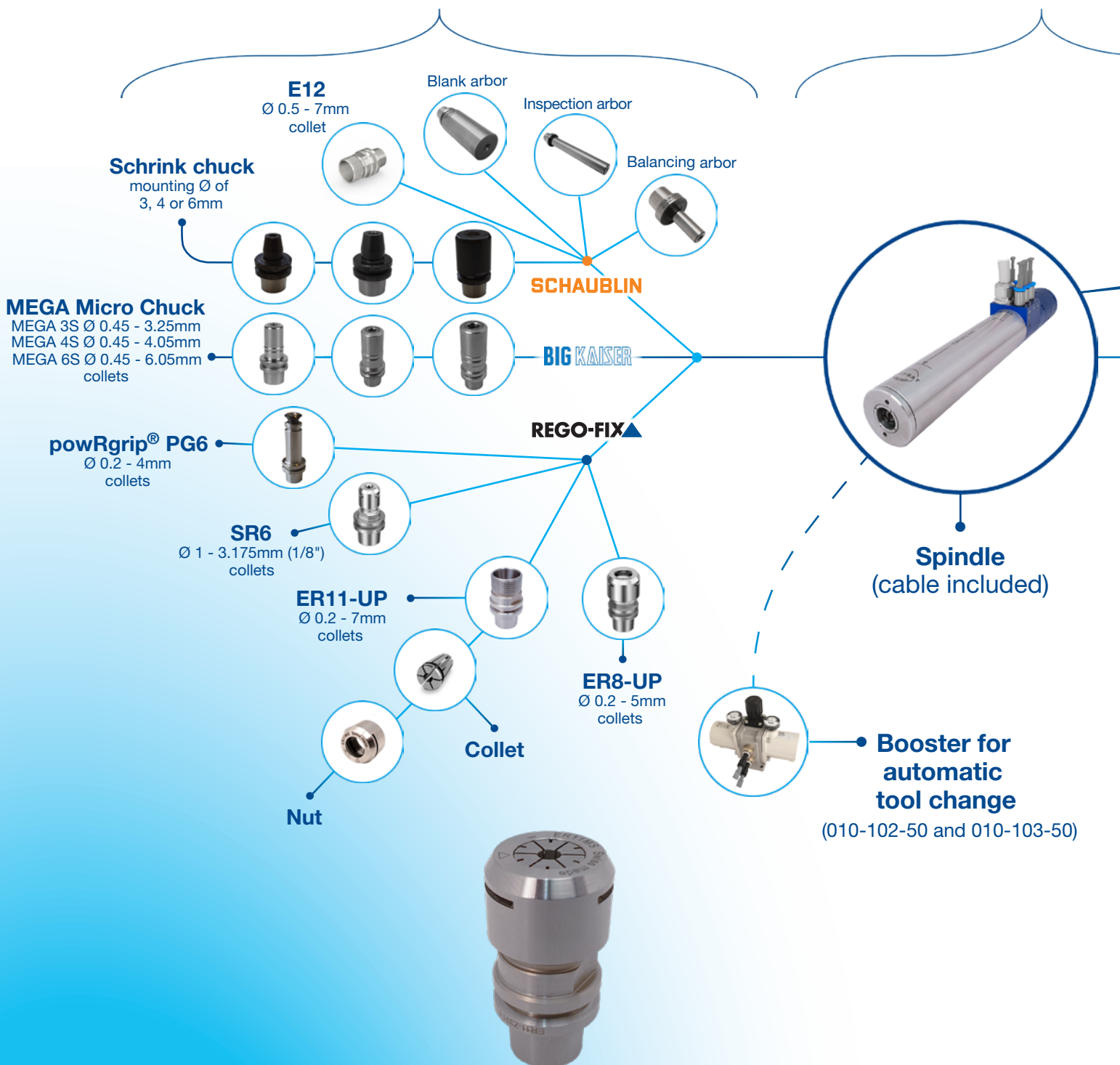

“The HSK-EZ15 standard is fully compatible with the ATC-E15 clamping system.”

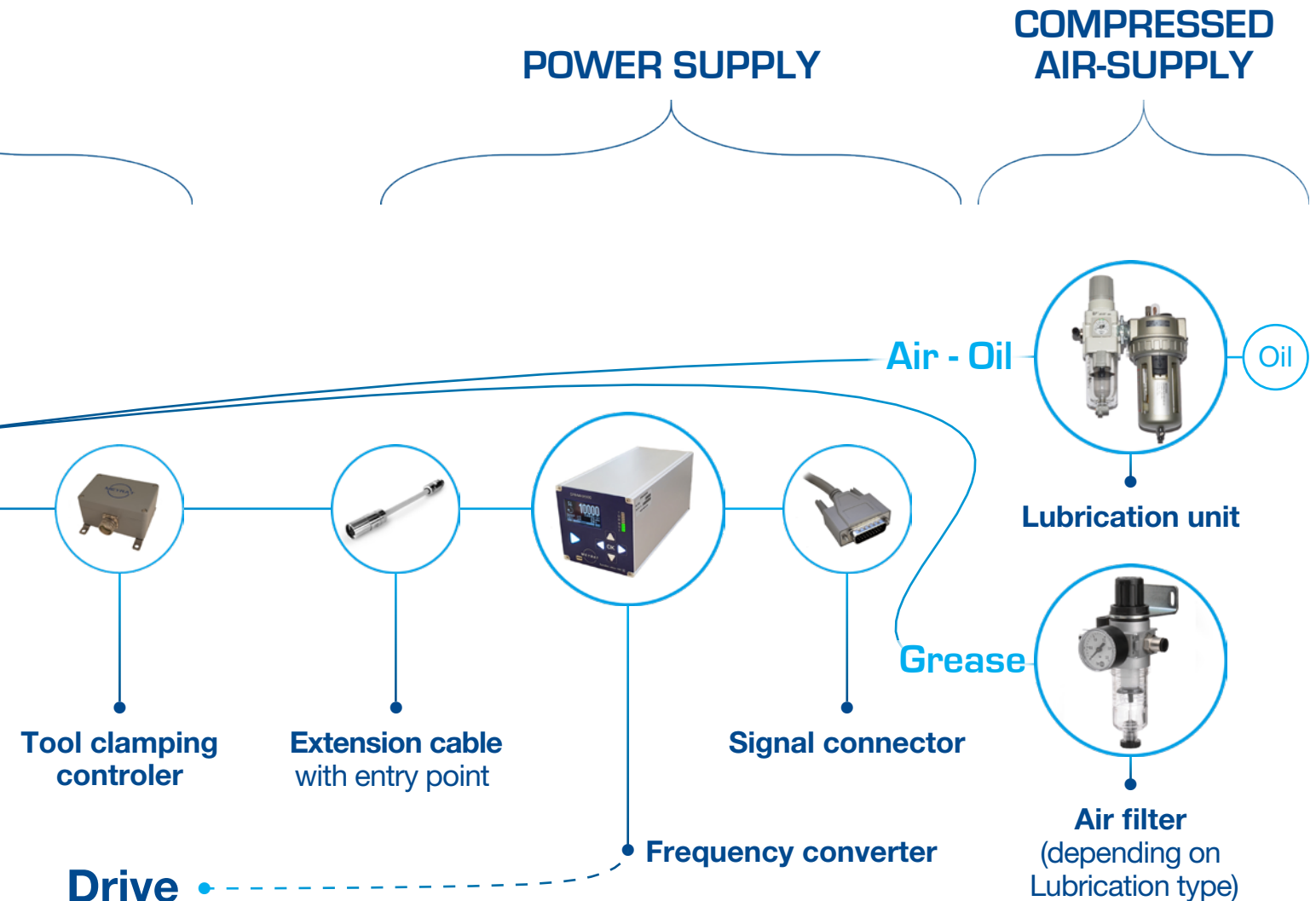

Drive

MEYRAT Frequency converter Type CFB-MHX500



Advantages and technical features:

Fully optimised for the use of MEYRAT spindles, the CFB-MHX500 frequency converters enable the ideal operation of any range of standard MEYRAT spindles with diameters from 16 to 30mm. Offering more versatility, the CFB-MHX500 Frequency Converter offers a range of features reworked to provide more efficiency and benefits, including:

- Plug and play for quick and easy installation
- Allows to drive 2 spindles sequentially
- Increased security with STO function
- Operating range for low speed machining
- Improved tool life by minimizing drift current
- Optimized for MEYRAT spindles from Ø 16 to 30mm
- Micro-USB accessible from the front





MEYRAT accessories table

DRIVE		Single output frequency converter with interface	CFB-MHX501A
		Single output frequency converter with interface with front plate	CFB-MHX501T
		Double output frequency converter with interface	CFB-MHX502A
		Double output frequency converter with interface with front plate	CFB-MHX502T
		Base plate for frequency converter	CFB-3739
SIGNAL CONNECTOR		Signal connector	RAL-XXX-ID26-4.5

ROTARY COUPLING		Coupler for 2 spindles	JTE-RC-2MM
------------------------	---	------------------------	------------

CABLES		Extension cable 2m with screw connection	RAL-AD9-AP9-2
		Extension cable 3m with screw connection	RAL-AD9-AP9-3
		Extension cable 5m with screw connection	RAL-AD9-AP9-5
		Extension cable 7m with screw connection	RAL-AD9-AP9-7
		Extension cable 9m with screw connection	RAL-AD9-AP9-9

AIR-OIL	LUBRICATION		Basis lubrication unit	DLB-MHX
			Lubrication unit with controller	DLB-MHX-CEVII
			Additional lubrication unit	DLB-MHX-AD
	OIL		Corex HLP ISO VG 32 1 liter	AHU-CorexHLP32
	AIR FILTER		Air filter unit G1/4 (2,5 bar)	DLB-SPN20
			Air filter unit G1/4 (4 bar)	DLB-SPN20X

ATC	TOOL CLAMPING CONTROLER		Tool clamping controller	CAP-ATC-1
	BOOSTER		Booster for automatic tool change	MPR-VBA10AF02GLS
	CLEANING CONE		E15 cleaning cone	HSK-ATCE15
	CONTROL PINULE		HSK-E15 Control pinule	TAS-ATC-E15-CTRL
	COMPENSATION STRIPS		Compensation strips	TAS-ATC-E15-EQ
	TENSION STRIPS		Tension strips	TAS-ATC-E15-EB





MEYRAT SA
Lengnaustrasse 10
CH-2504 Biel/Bienne

www.meyrat.com
info@meyrat.com
sales@meyrat.com

T +41 32 344 70 20
F +41 32 344 70 29

TOOL HOLDERS	 TOOL HOLDER (delivered with nut)	SCHAUBLIN	3mm shrink chuck tool holder
		4mm shrink chuck tool holder	
		6mm shrink chuck tool holder	
		E12 tool holder	
		BIG KAISER	MEGA3S tool holder
		MEGA4S tool holder	
		MEGA6S tool holder	
		REGO-FIX	ER8 tool holder
		ER11 tool holder	
		SR6 tool holder	
		powRgrip® PG6 tool holder	

NUTS	 NUT	Nut E12
		Nut MEGA3S
		Nut MEGA4S
		Nut MEGA6S
		Nut SR6
		Nut ER8-UP
		Nut ER11-UP
		Nut SR6

COLLETS	 COLLET	E12/0.5 - 7.0 mm	SR6 COLLETS	Clamping collet 1,0 mm
		MEGA3S-25T-75T/0.45 - 3.25 mm		Clamping collet 1,5 mm
		MEGA4S-60T-75T/0.45 - 4.05 mm		Clamping collet 2,0 mm
		MEGA6S-45T-120T/0.45 - 6.05 mm		Clamping collet 3,0 mm
		SR6/1.0 - 3.175 mm		Clamping collet 1/8" [3,175 mm]
		PG6 powRgrip®/0.2 - 4.0 mm		
		ER8-UP/1.0 - 5.0 mm		
		ER11-UP/1.0 - 7.0 mm		



People. Passion. Precision.
Spindles since 1947. 

