



# MEYRAT STANDARDS

---

## HIGH PRECISION SPINDLES



# Looking for a competitive advantage?

Founded 1947 in Bienne a region recognized as the Swiss birthplace of machine tools, **MEYRAT SA** develops and manufactures customized and MEYRAT standard spindles for small to medium sized machines.

## MEYRAT helps you to gain competitive advantage through spindle technology with:

### *“Superior performance”*

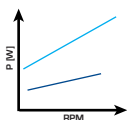

- Better torque
- More dynamics
- Less consumption
- High RPM
- Smaller diameter
- Etc.

### *“Higher precision”*



- Lower run-out
- Less vibrations
- Better thermal stability
- Etc.

### *“Higher reliability”*



- MEYRAT swiss conception
- MEYRAT craftsmanship
- Best components chosen
- Higher uptime achieved
- Etc.

### *“Better value add for you and your customers”*



- Innovative solutions
- New features like automatic tool change
- New controls, measuring & monitoring options
- Etc.

### *“Efficient services”*



- MEYRAT know-how
- SpinCare, revision and repair service
- Performed by our skilled technicians
- Etc.

# Table of contents



EDITORIAL	2
TABLE OF CONTENTS	3
INDUSTRIES	4
APPLICATIONS	5
LEADING-EDGE TECHNOLOGY	6
<b>MHF-HIGH FREQUENCY SPINDLES</b>	<b>8</b>
MHF-16	10
MHF-19	11
MHF-20	12
MHF-22	14
MHF-25	16
MHF-30	17
MHF-35 AUTOMATIC TOOL CHANGE	18
MHF-45 AUTOMATIC TOOL CHANGE	19
MHF-80	20
<b>MHT-HIGH TORQUE SPINDLES</b>	<b>22</b>
MHT-25	24
MHT-30	25
MHT-30 IKZ	26
MHT-30 AUTOMATIC TOOL CHANGE	27
MHT-45 AUTOMATIC TOOL CHANGE	29
<b>MDS-DRESSING SPINDLES</b>	<b>30</b>
MDS-38	32
MDS-58	33
MDS-72	34
MDS-76 / 78	35
SPINDLE SYSTEM & COUPLING	36
ATC SPINDLE SYSTEM & DRIVE	38
ACCESSORIES TABLE	40
CONTACT	41

# Industries

Your experienced and reliable partner for industries like:



Aerospace



Automotive



Dental



Electronics



Medtech



Optics



Tooling



Watches



Wood

# Applications



Leading solutions for your applications requirements, such as:

Cutting



Dressing



Drilling



EDM



Etching



Grinding



Swiss lathing



Milling



Turning



## Bearing system

**Hybrid ball bearings:** ultra-resistant steel/inox ring with ceramic balls lubricated with grease or air-oil that can withstand very high temperatures and speeds.

### Classic ball bearings:

Steel/inox ball bearings satisfying high requirements on speed strength, load capacity and stiffness.

### Ceramic ball bearings:

For extreme environment and conditions (e.g. corrosion, space conditions, ...)

## Lubrication

Grease or Air-Oil (with diffusor)

## Cooling systems

**Air cooling system:** air forced or natural convection.

- Low consumption
- Environment protection
- Protection by air overpressure

**Liquid cooling system:** water or oil to stabilize spindle temperature regardless of its rotating speed:

- Perfect precision and stability at tool end
- Temperature stability
- Long lifetime and reliability

## Through-spindle coolant (IKZ)

Internal coolant (through the tool) system

- High pressure by rotary seal.
- Dispenser crown.
- Auxiliary nozzle.

## Tool interface

Most efficient and reliable standard clamping systems of the market:

- HSK, ISO, Capto, ETA, ER and outside Ø.
- Customized tool interface system according to customer's requests.

## Clamping system

Manual or automatic.

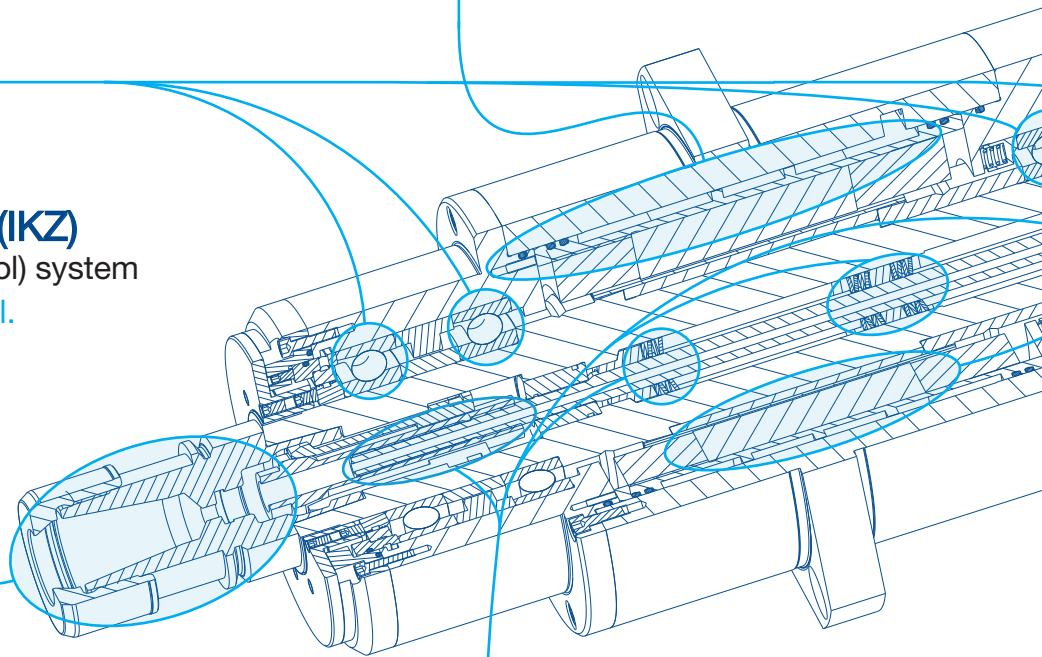

## Drive system

**AC / DC / Torque motors:** our synchronous, asynchronous or torque motors are tailored according to specific characteristics and performances required by target application.

**Belt driven system:** Simple construction that permits the transmission of large torques in restricted overall dimensions.

## Connecting orientation

- Axial

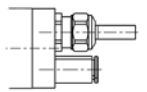

- Radial

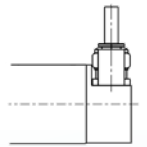

- Front

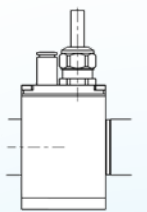

## Release system

Pneumatic, hydraulic or by external action.

## Peripheral devices

MEYRAT can advise and validate the choice of peripheral equipment, such as:

- Frequency converters
- Chiller
- Lubrication unit and oil
- Air filter
- Extension cables
- Rotary coupling
- ... and many others

## Monitoring and data collection

For optimal driving during production cycle, MEYRAT spindles incorporate state-of-the-art control technology, such as:

- Bearings and motor temperature measurements
- Accelerometer (crash detection)
- Spindle nose expansion sensor (thermal)
- Analog / digital sensors (tool clamping)
- 1Vpp encoder (sin - cos)
- Acoustic Emissions Sensors (AE sensors)
- Monitoring of electrical current or apparent power
- ... and more depending on your requirements.

# MEYRAT HIGH FREQUENCY

spindle range

- Up to 80'000 rpm
- Ø 16 - 80mm
- Low run-out: < 1 µm
- Excellent stiffness
- Ultra-high level of precision
- Efficient and high qualitative machining
- ATC-E15 - Automatic Tool Change













# MHF

STANDARD  
MHF

							
16 - 80 mm	40'000 - 80'000 rpm	Synchron	80 W to 3,8 kW	1,0 Ncm to 100 Ncm	SR6 ER8-UP ER11-UP HSK-E20 HSK-E25 ATC-E15	Grease or Air-Oil	Excellent stiffness that gives your machining an ultra-high level of precision (< 1µm run-out).

Exclusively developed and manufactured in Switzerland, our MHF (MEYRAT High Frequency) spindle range offers an efficient universal / micro machining with the highest precision and performance.

With plug-and-go equipment, the spindles are easy to install and require only minimal maintenance.

-  Diameter
-  Length (mm)
-  Connecting orientation
-  Motor type
-  RPM (min<sup>-1</sup>)
-  Tool interface
-  Power (w)
-  Torque
-  Lubrication
-  Other
-  Article Nr

# MHF-16

MEYRAT HIGH FREQUENCY SPINDLES

## MHF-16 AXIAL 010-159-00

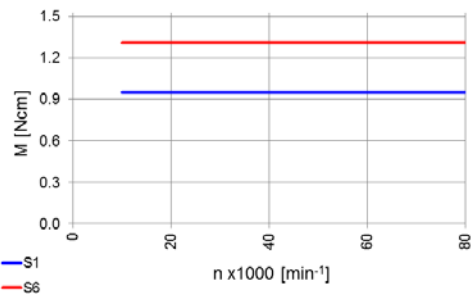
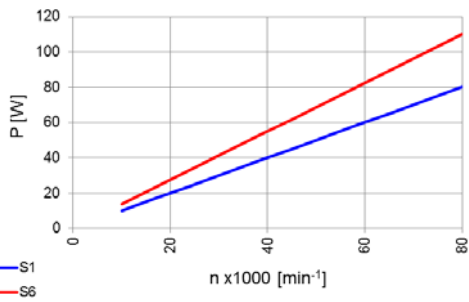
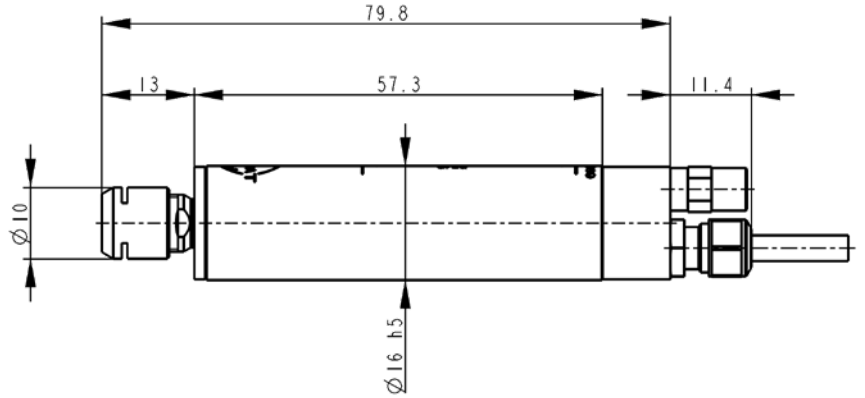

## MHF-16 RADIAL 010-159-50

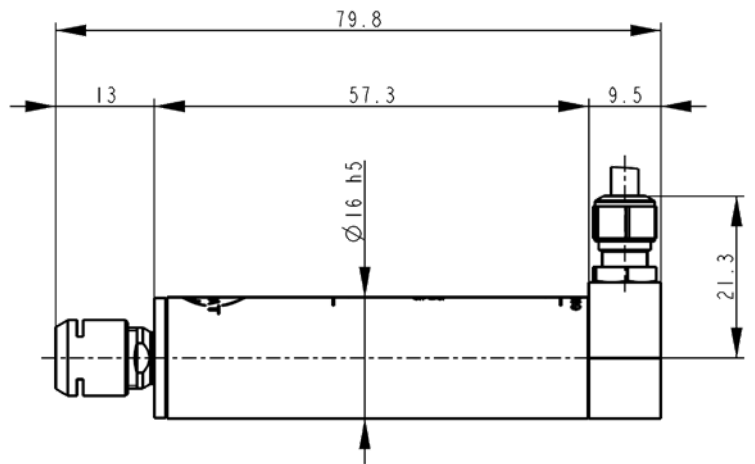

STANDARD <b>MHF</b>	16 mm	79.8 mm	Axial	Synchron	80'000 rpm	SR6	S1=80 W	S1=1.0 Ncm	Grease	Air cooling	010-159-00
			Radial				S6=110 W	S6=1.3 Ncm			010-159-50

MHF

# MHF-19

MEYRAT HIGH FREQUENCY SPINDLES



## MHF-19 AXIAL 010-158-00\*

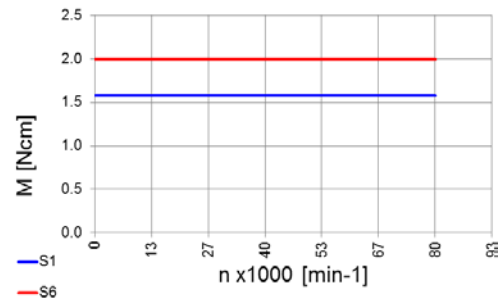
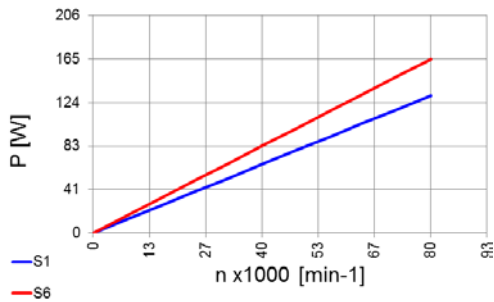
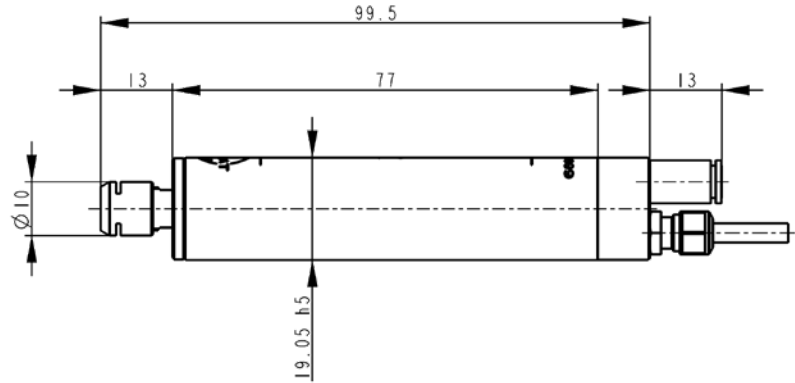

## MHF-19 RADIAL 010-158-50

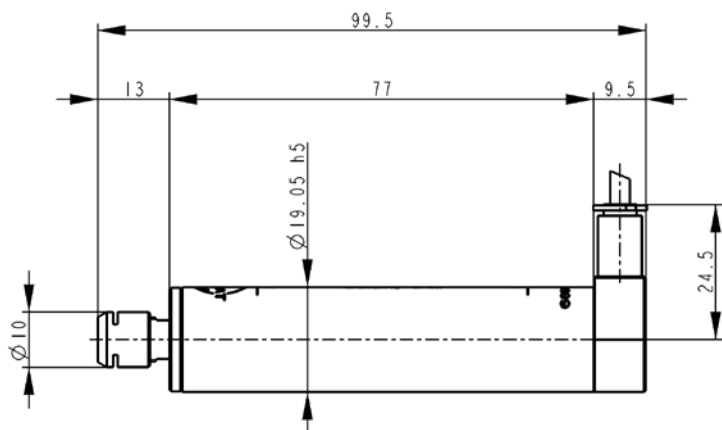

STANDARD <b>MHF</b>	19 mm	99.5 mm	Axial	Synchron	80'000 rpm	SR6	S1=135 W S6=165 W	S1=1.6 Ncm S6=2.0 Ncm	Grease	Air cooling	010-158-00
		86.5 mm	Radial								010-158-50
			Front								010-72-50

\* Pictures of ETA6-UP version

# MHF-20

MEYRAT HIGH FREQUENCY SPINDLES

## MHF-20 AXIAL

010-163-00\*  
as example

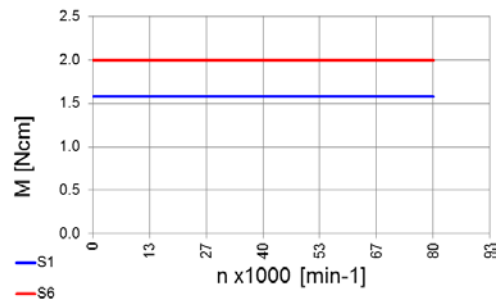
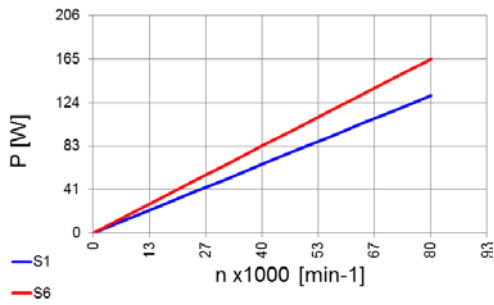
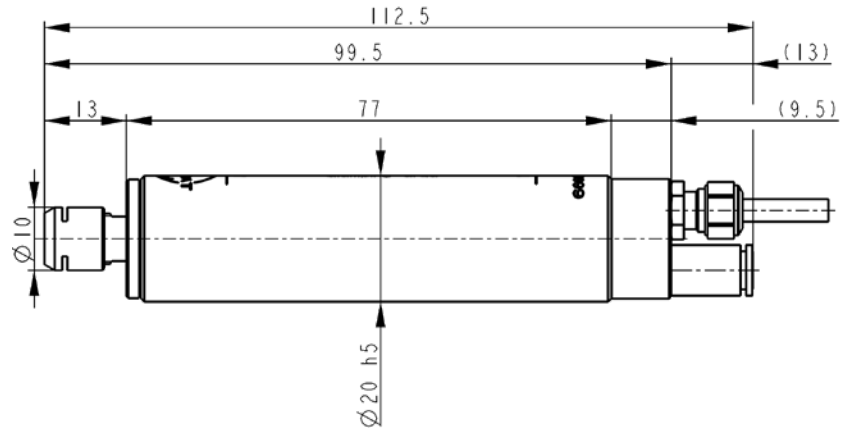

## MHF-20 RADIAL

010-163-50\*  
as example

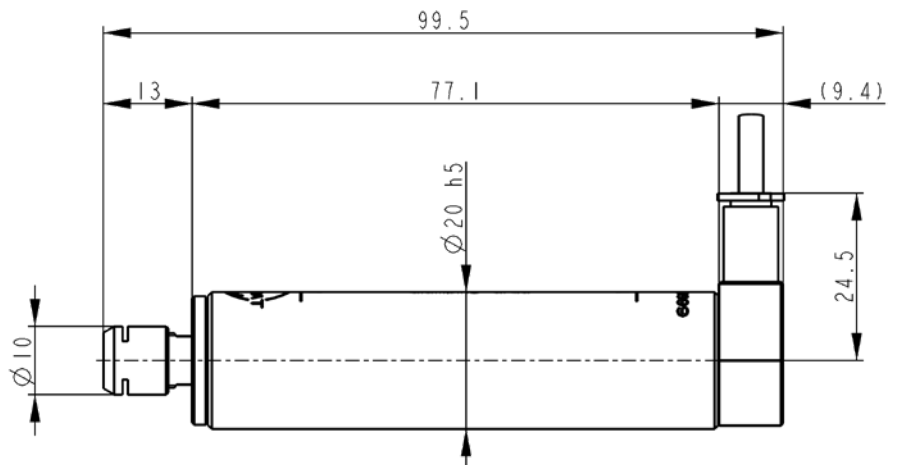

MHF

# MHF-20

MEYRAT HIGH FREQUENCY SPINDLES



**MHF-20**  
**FRONT**  
010-71-50  
as example

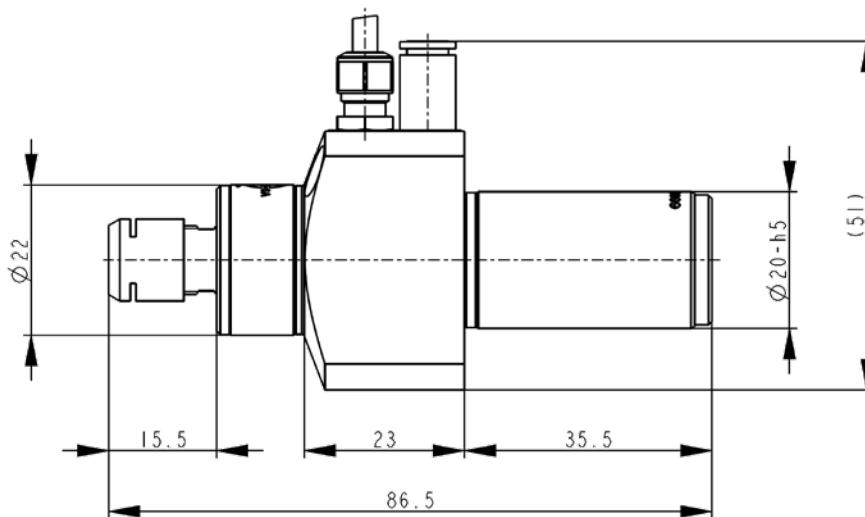
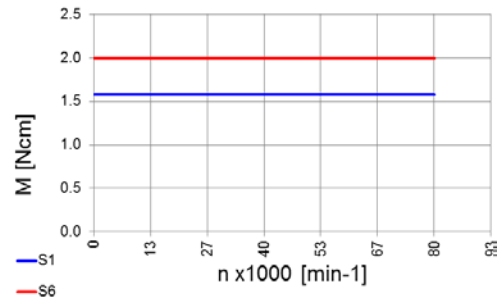
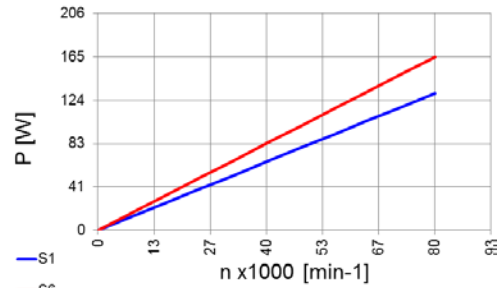

STANDARD <b>MHF</b>	20 mm	99.5 mm	Axial	Synchron	80'000 rpm	SR6	S1=135 W S6=165 W	S1=1.6 Ncm S6=2.0 Ncm	Grease	Air cooling	010-163-00
		86.5 mm	Radial								010-163-50
			Front								010-71-50

\* Pictures of ETA6-UP version

# MHF-22

MEYRAT HIGH FREQUENCY SPINDLES

**MHF-22**  
**AXIAL**  
010-21-00  
as example

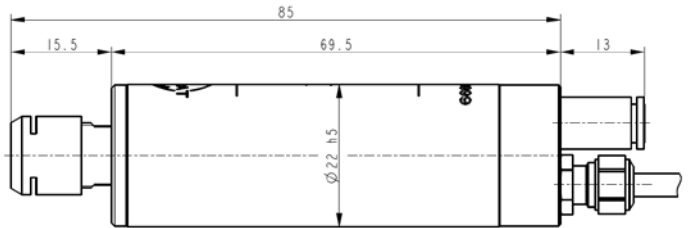

**MHF-22**  
**RADIAL**  
010-21-50  
as example

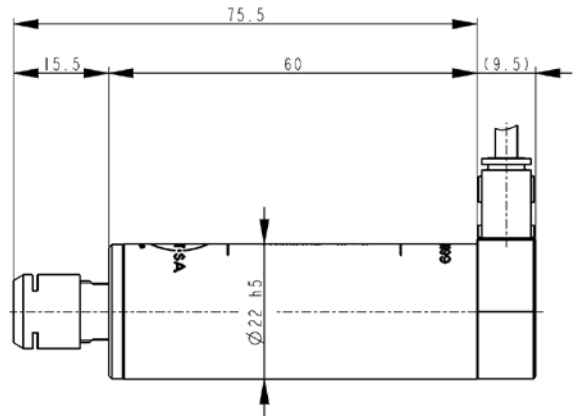

**MHF-22**  
**RADIAL**  
010-24-50  
as example

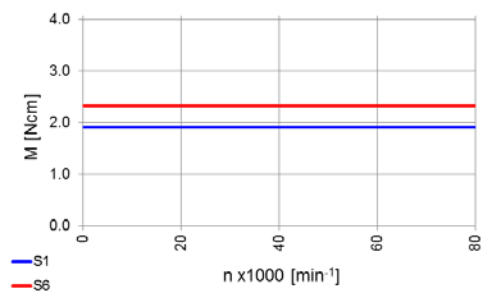
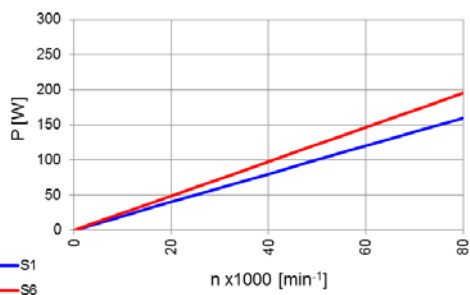
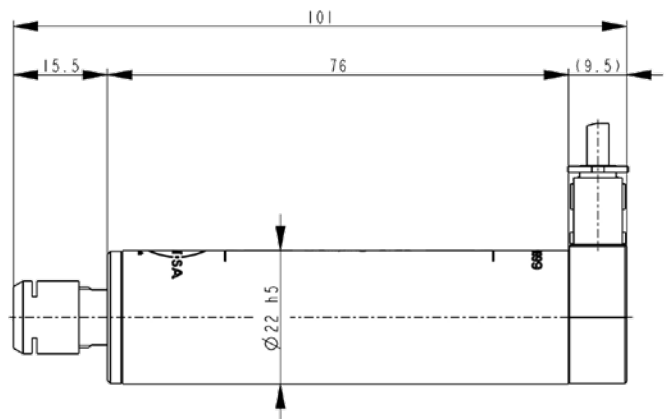

MHF

# MHF-22

MEYRAT HIGH FREQUENCY SPINDLES



MHF-22  
FRONT  
010-101-50  
as example

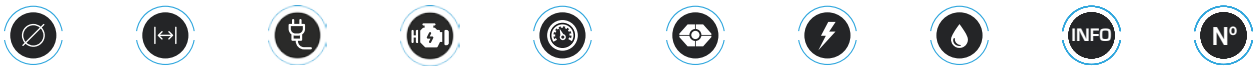
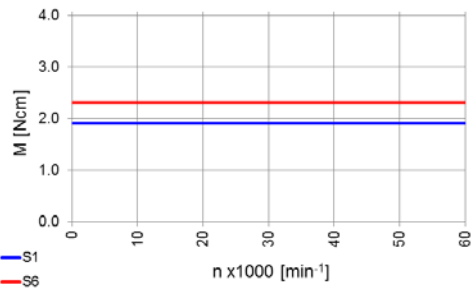
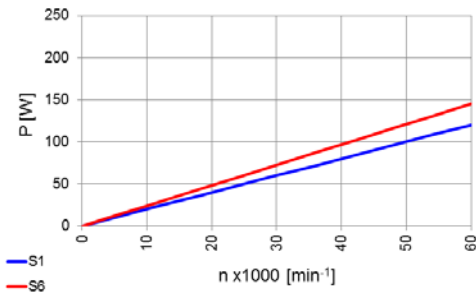
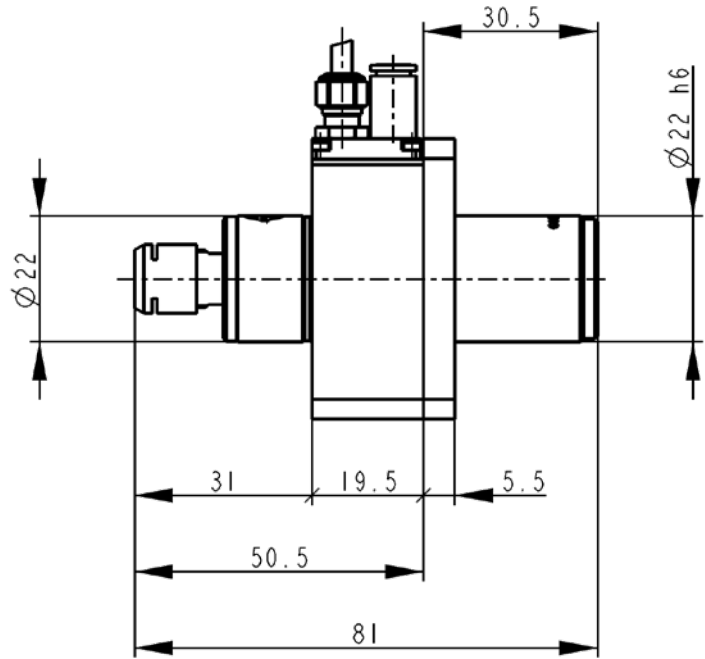

STANDARD MHF	22 mm	85 mm	Axial	Synchron	ER8-UP	S1 = 120 W S6 = 145 W	Grease	Air cooling	010-21-00	
			Radial			S1 = 160 W S6 = 195 W	Air - Oil		010-22-00	
		101 mm	Axial			S1 = 120 W S6 = 145 W	Grease		010-21-50	
			Radial			S1 = 160 W S6 = 195 W	Air - Oil		010-22-50	
		81.5 mm	Front			60'000 rpm	S1 = 120 W S6 = 145 W		Grease	010-23-00
						80'000 rpm	S1 = 160 W S6 = 195 W		Air - Oil	010-24-00
			60'000 rpm			S1 = 120 W S6 = 145 W	Grease		010-23-50	
		80'000 rpm	S1 = 160 W S6 = 195 W			Air - Oil	010-24-50			
		60'000 rpm	S1 = 120 W S6 = 145 W			Grease	010-36-50			

MHF

# MHF-25

MEYRAT HIGH FREQUENCY SPINDLES

## MHF-25 AXIAL 010-40-00 as example

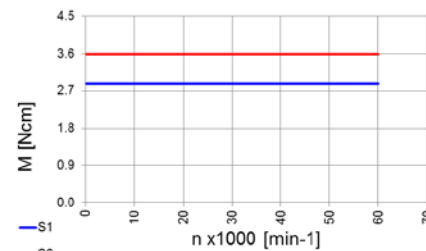
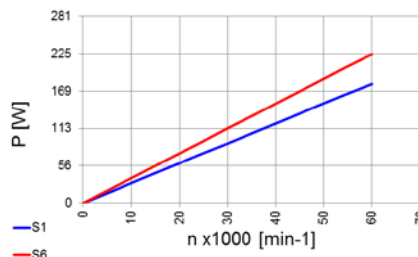
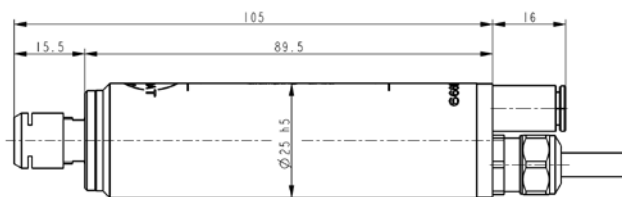

## MHF-25 RADIAL 010-41-50 as example

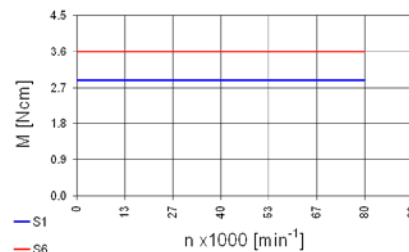
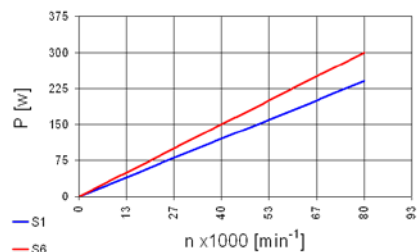
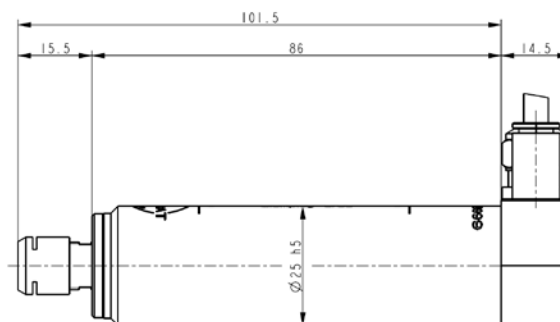

MHF



STANDARD MHF	25 mm	105 mm	Axial	Synchron	ER8-UP	Power		S1=2.9 Ncm S6=3.6 Ncm	Cooling	Part No.
						S1	S6			
						60'000 rpm	S1=180 W S6=225 W		Grease	010-40-00
						80'000 rpm	S1=240 W S6=300 W		Air - Oil	010-41-00
		116 mm	Radial			60'000 rpm	S1=180 W S6=225 W		Grease	010-40-50
						80'000 rpm	S1=240 W S6=300 W		Air - Oil	010-41-50
		137 mm	Axial			60'000 rpm	S1=180 W S6=225 W		Grease	010-42-00
						80'000 rpm	S1=240 W S6=300 W		Air - Oil	010-43-00
		148 mm	Radial			60'000 rpm	S1=180 W S6=225 W		Grease	010-42-50
						80'000 rpm	S1=240 W S6=300 W		Air - Oil	010-43-50



# MHF-30

MEYRAT HIGH FREQUENCY SPINDLES



## MHF-30 AXIAL

010-112-00  
as example

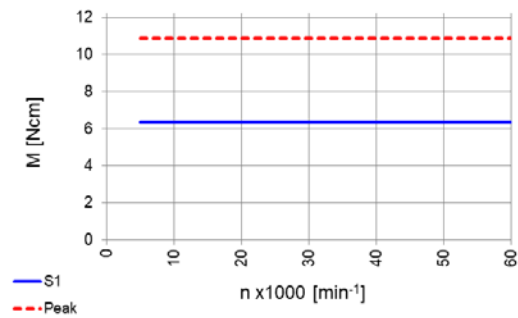
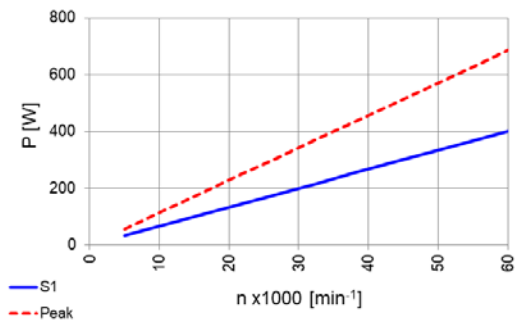
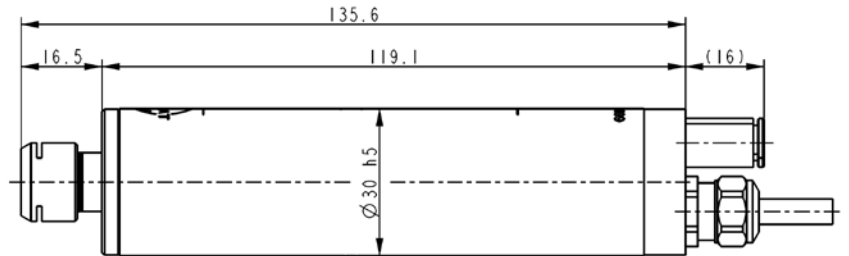

## MHF-30 RADIAL

010-112-50  
as example

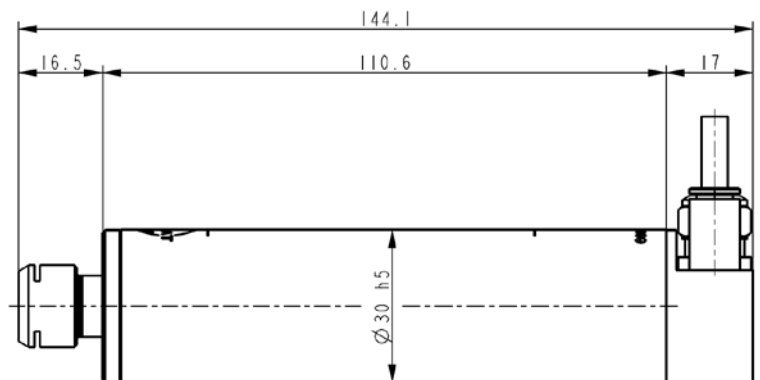

STANDARD MHF	30 mm	135.6 mm	Axial	Synchron	ER11-UP	S1=400 W S6=500 W		S1=6.4 Ncm S6=7.3 Ncm	Grease	Air cooling	010-112-00	
						S1=535 W S6=670 W					Air - Oil	010-113-00
						S1=400 W S6=500 W					Grease	010-112-50
						S1=535 W S6=670 W					Air - Oil	010-113-50
		144.1 mm	Radial									

# MHF-35 ATC

MEYRAT HIGH FREQUENCY SPINDLES

MHF-35 ATC

**AXIAL**

010-146-00

as example

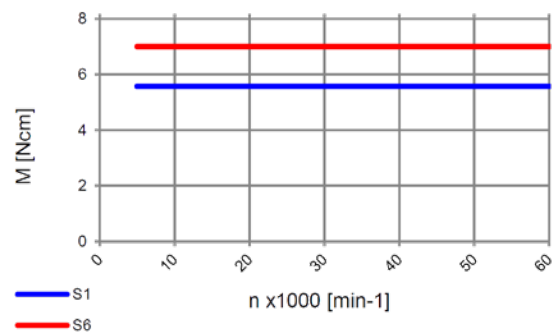
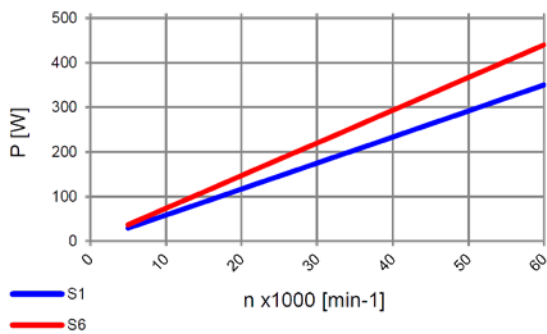
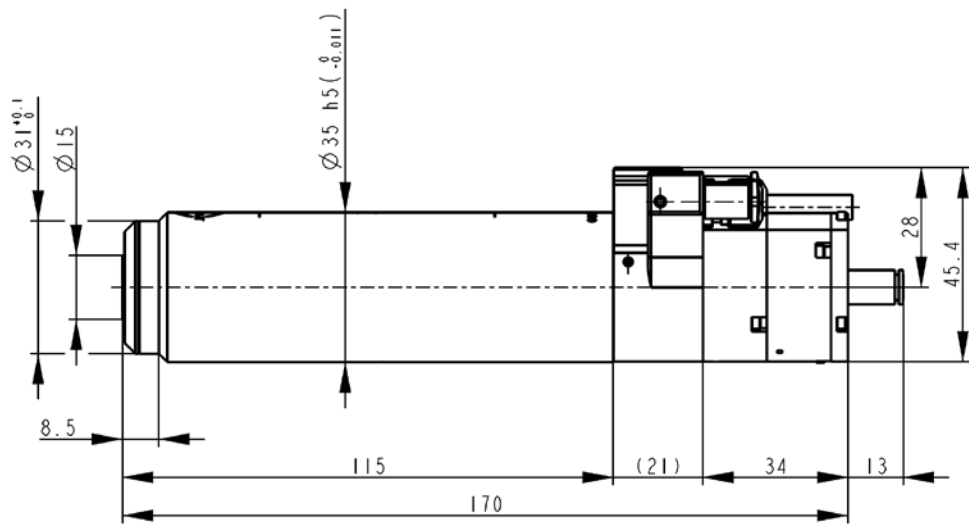

STANDARD <b>MHF</b>	35 mm	170 mm	Axial	Synchron	60'000 rpm	ATC-E15	S1=350 W S6=440 W	S1=5.6 Ncm S6=7.0 Ncm	Grease	5 bar* Tool Clamping Control Air cooling	010-146-00
------------------------	-------	--------	-------	----------	------------	---------	----------------------	--------------------------	--------	--	------------

\* pneumatic release unit

MHF

# MHF-45 ATC

MEYRAT HIGH FREQUENCY SPINDLES



**MHF-45  
AXIAL**  
010-137-00  
as example

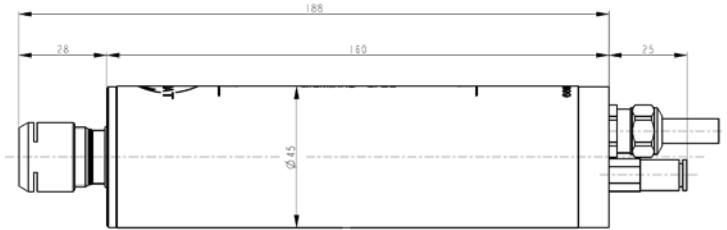

**MHF-45  
RADIAL**  
010-137-50  
as example

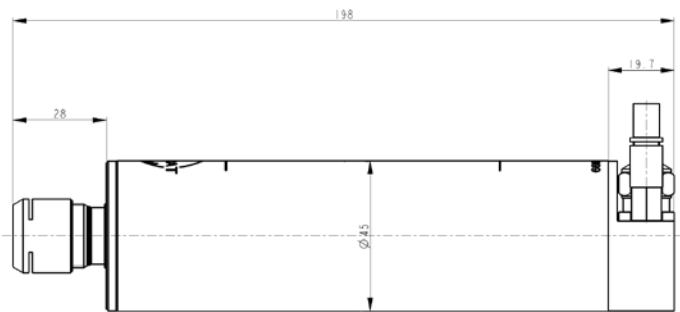

**MHF-45  
RADIAL**  
010-140-50  
as example

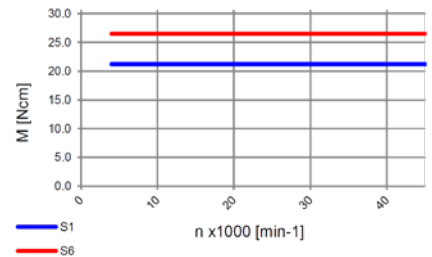
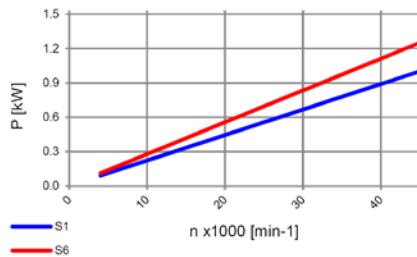
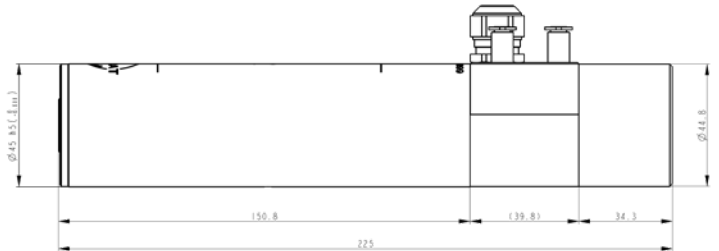

MHF



STANDARD <b>MHF</b>	45 mm	188 mm	Axial	Synchron	45'000 rpm	ER16	S1=1000 W S1=21.2 Ncm S6=1300 W S6=26.5 Ncm	Grease	Air cooling	010-137-00
		198 mm	Radial						Air cooling	010-137-50
		225 mm							Air cooling 5 bar* Tool Clamping Control	010-140-50

\* pneumatic release unit

# MHF-80

MEYRAT HIGH FREQUENCY SPINDLES

**MHF-80**  
**AXIAL**  
010-141-00  
as example

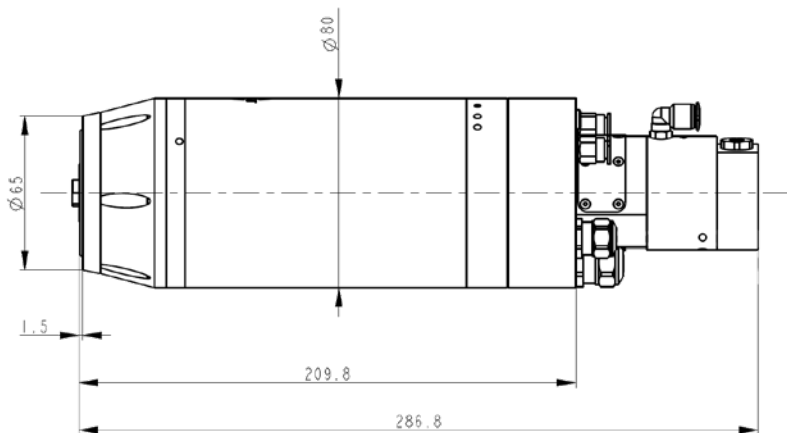

**MHF-80**  
**AXIAL**  
010-144-00  
as example

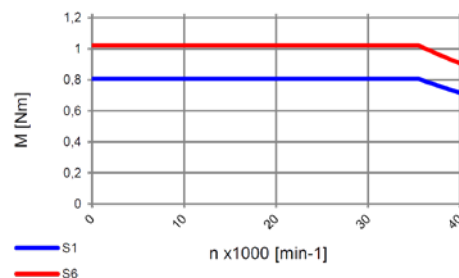
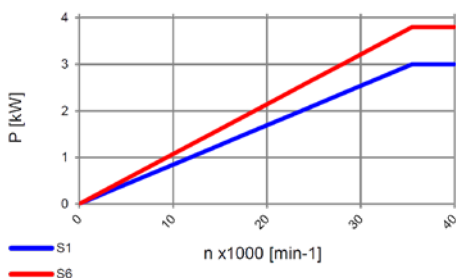
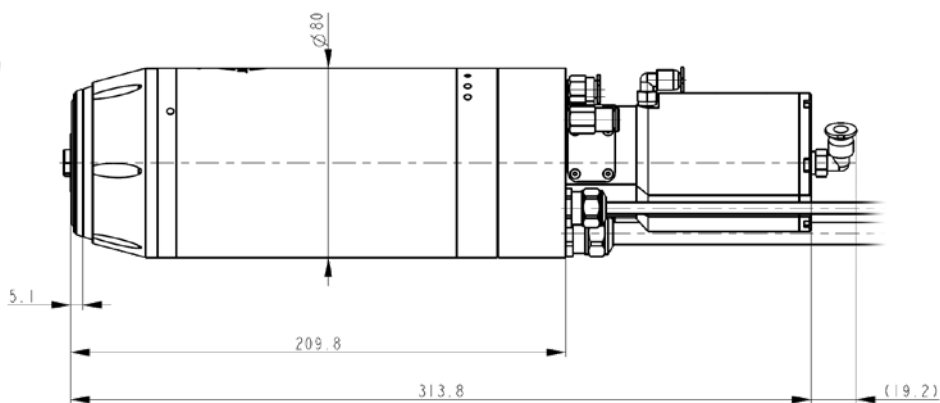

AVAILABLE  
OPTIONS

Encoder
Pneumatic cylinders
Bearing temperature sensors
Rotary joint



STANDARD MHF	80 mm	286.8 mm	Axial	Synchron	40'000 rpm	HSK-E25	S1=3 KW	S1=80 Ncm	Grease	Water cooling	010-141-00
		313.8 mm			60'000 rpm		S6=3.8 KW	S6=100 Ncm			Air - Oil

**PEOPLE.**



**PASSION.**



**MHF**

**PRECISION.**



# MEYRAT HIGH TORQUE

spindle range

- High torque
- Ø 25 - 45mm
- 6 to 70Ncm
- Up to 40'000 rpm
- ER Clamp
- ATC-E15 - Automatic Tool Change
- Same compact design as corresponding MHF spindles

# MHT











STANDARD  
MHT



25 - 45 mm	20'000 - 40'000 rpm	Synchron	240 W to 1,6 kW	5,7 Ncm to 70 Ncm	ER8-UP ER11-UP ER16-UP HSK-E20 ATC-E15	Grease or Air-Oil	High torque for high performances (3 to 4x more torque compared to MHF of the same Ø).  Also with through-spindle/tool coolant (IKZ).
------------	------------------------------	----------	-----------------------	-------------------------	--	-------------------------	--

Exclusively developed and manufactured in Switzerland, our MHT (MEYRAT High Torque) spindle range is built for challenging applications requiring high torque in confined spaces, and allows a higher productivity and a perfect surface finish.

Ideal for universal applications such as cutting, dressing, drilling, etching, forming, grinding, milling, swiss lathing, turning, etc.

-  Diameter
-  Length (mm)
-  Connecting orientation
-  Motor type
-  RPM (min<sup>-1</sup>)
-  Tool interface
-  Power (w)
-  Torque
-  Lubrication
-  Other
-  Article Nr

# MHT-25

MEYRAT HIGH TORQUE SPINDLES

**MHT-25**  
**AXIAL**  
010-44-00  
as example

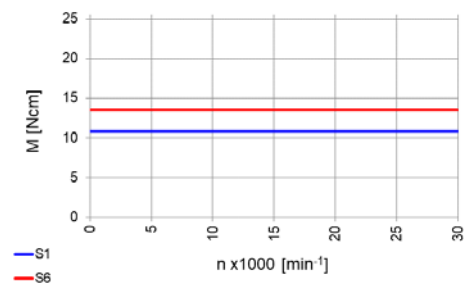
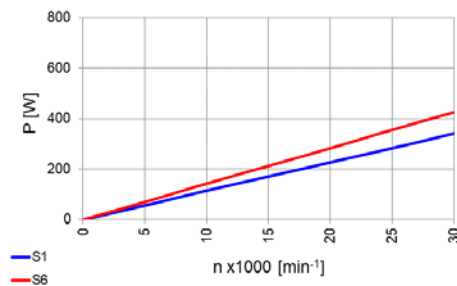
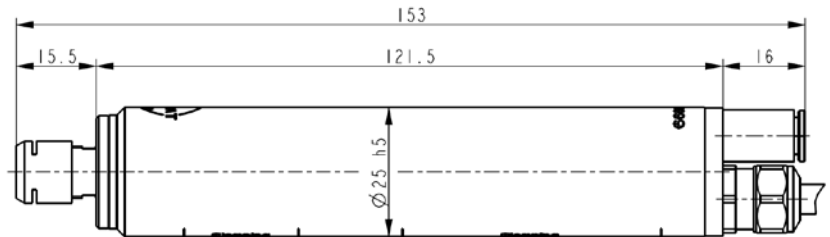

MHT

**MHT-25**  
**RADIAL**  
010-44-50  
as example

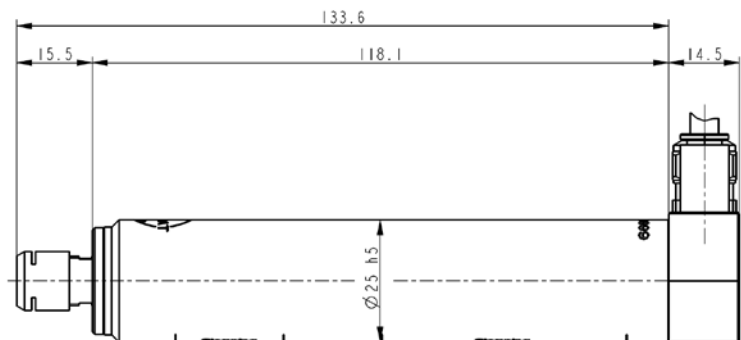

STANDARD <b>MHT</b>	25 mm	137 mm	Axial	Synchron	30'000 rpm	ER8-UP	S1=340 W S6=425 W	S1=10.8 Ncm S6=13.5 Ncm	Grease	Air cooling	010-44-00
		133.6 mm	Radial						Air - Oil		010-45-00
	Grease								010-44-50		
	Air - Oil	010-45-50									



# MHT-30

MEYRAT HIGH TORQUE SPINDLES



## MHT-30 AXIAL 010-74-00 as example

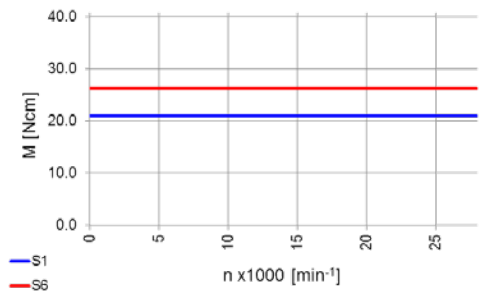
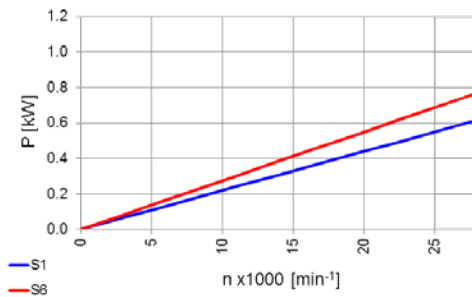
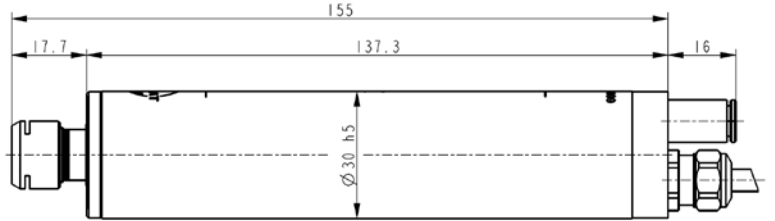

## MHT-30 RADIAL 010-75-50 as example

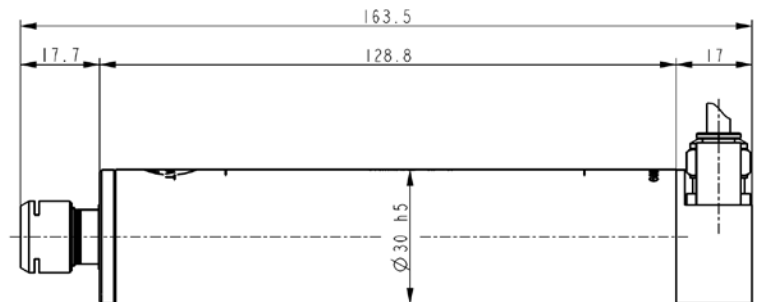

STANDARD MHT	30 mm			Synchron	28'000 rpm	ER11-UP	S1=615 W S6=770 W	S1=21.0 Ncm S6=26.3 Ncm	Grease	Air cooling	010-74-00
		155 mm	Axial						Air - Oil		010-75-00
		146.5 mm	Radial						Grease		010-74-50
									Air - Oil		010-75-50

MHT

# MHT-30 IKZ

MEYRAT HIGH TORQUE SPINDLES

MHT-30 IKZ

**AXIAL**

010-77-00  
as example



Through-spindle coolant (IKZ)

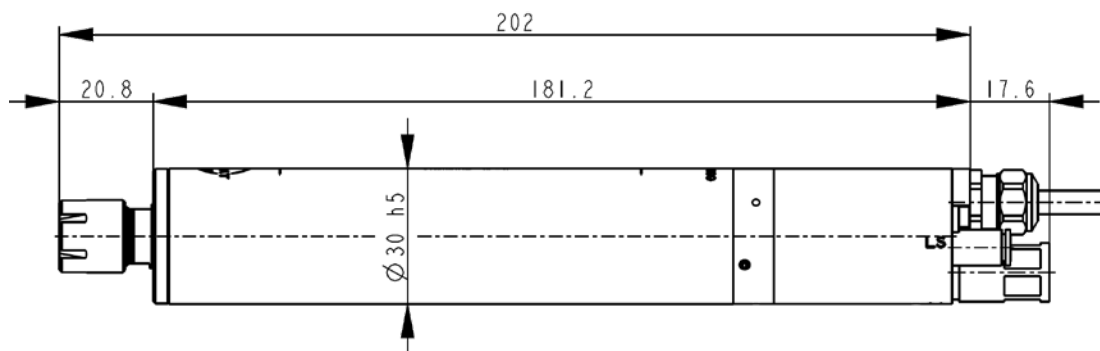
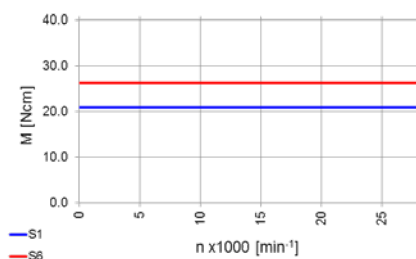
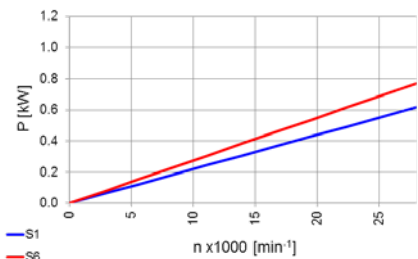

STANDARD <b>MHT</b>	30 mm	202 mm	Axial	Synchron	28'000 rpm	ER11-UP	S1=615 W S6=770 W	S1=21.0 Ncm S6=26.3 Ncm	Grease	Through-spindle coolant (IKZ)	010-76-00
									Air - Oil		010-77-00

MHT



# MHT-30 ATC

MEYRAT HIGH TORQUE SPINDLES



*“Faster and more precise tool change with our ATC-System!”*

MHT-30 ATC-E15

**RADIAL**

010-102-50  
as example

Booster for MHT-30 ATC-E15  
010-102-50 / 010-103-50

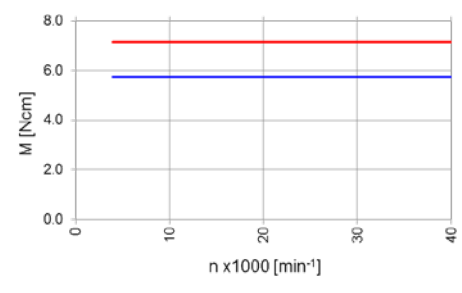
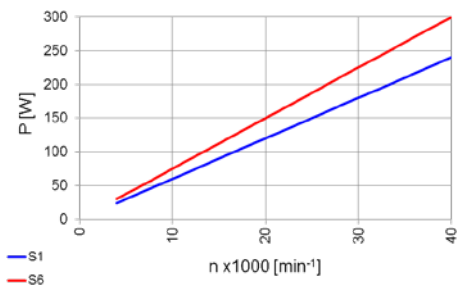
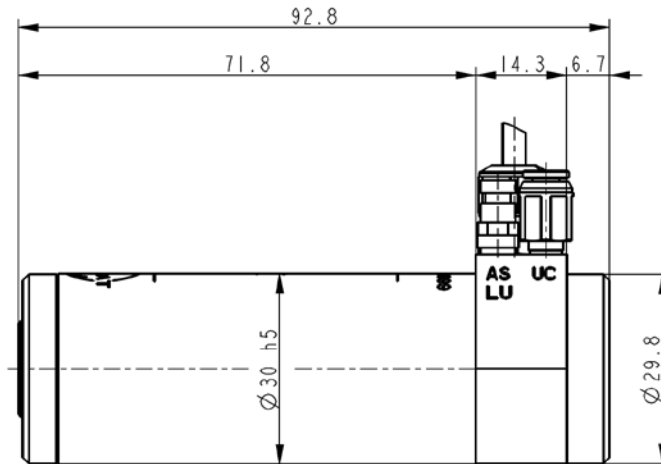

STANDARD <b>MHT</b>	30 mm	92.8 mm	Radial	Synchron	40'000 rpm	ATC-E15	S1=240 W S6=300 W	S1=5.7 Ncm S6=7.2 Ncm	Grease	12 bar* Tool Clamping Control	010-102-50
									Air - Oil	Air cooling	010-103-50

\* pneumatic release unit

MHT

# MHT-30 ATC

MEYRAT HIGH TORQUE SPINDLES

## MHT-30 ATC-E15

**AXIAL**  
010-133-00  
as example

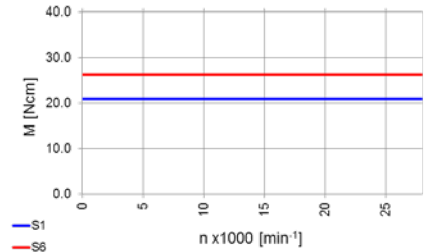
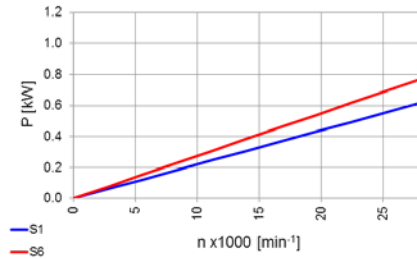
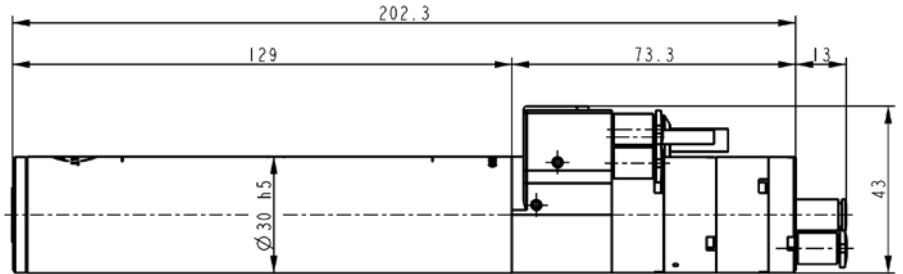

## MHT-30 ATC-E15

**RADIAL**  
010-133-50  
as example

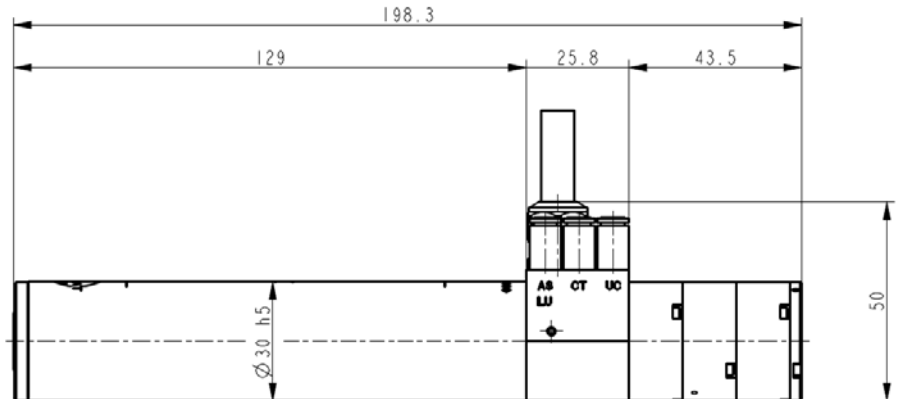

STANDARD MHT	30 mm	198.3 mm	Radial	Synchron	28'000 rpm	ATC-E15	S1=615 W S6=770 W	S1=21 Ncm S6=26.3 Ncm	Grease	5 bar* Tool Clamping Control	010-133-50
		202.3 mm	Axial						Air - Oil		010-134-50
									Grease		Air cooling
		Air - Oil							010-134-00		

\* pneumatic release unit

# MHT-45 ATC

MEYRAT HIGH TORQUE SPINDLES



**MHT-45  
AXIAL**  
010-136-00  
as example

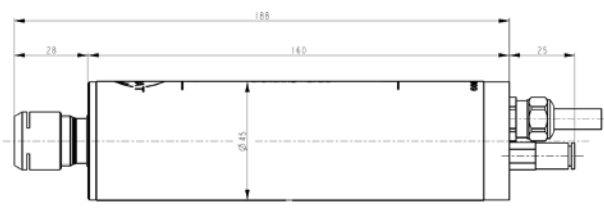

**MHT-45  
RADIAL**  
010-136-50  
as example

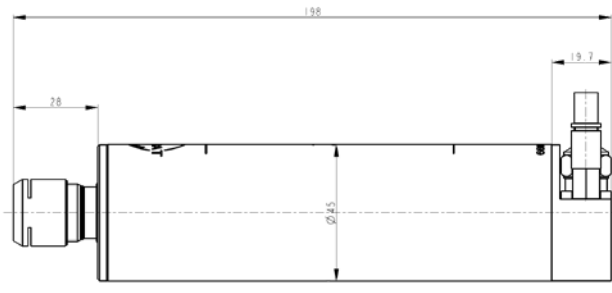

**MHT-45  
RADIAL**  
010-139-50  
as example

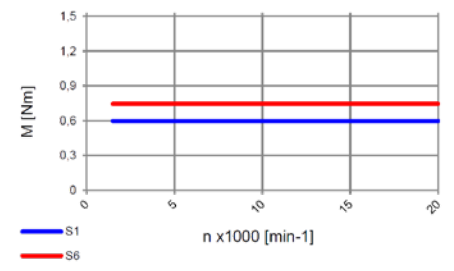
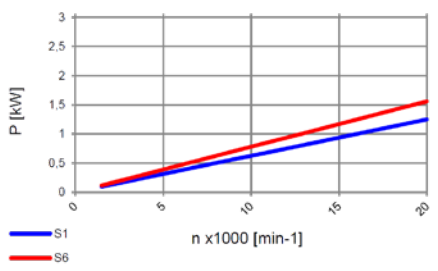
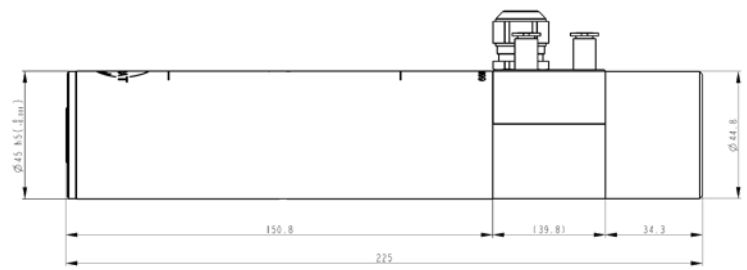

- 
- 
- 
- 
- 
- 
- 
- 
- 
- 
- 

<b>STANDARD MHT</b>	45 mm	188 mm	Axial	Synchron	20'000 rpm	HSK-E20 ATC	S1=1300 W S6=1600 W	S1=60 Ncm S6=70 Ncm	Grease	Air cooling	010-136-00
		198 mm	Radial							Air cooling	010-136-50
	225 mm	Radial	Air cooling 5 bar* Tool Clamping Control							010-139-50	
	215 mm	Axial	Through-spindle coolant (IKZ)							010-138-00	
		Radial	010-138-50								

\* pneumatic release unit

**MHT**

# MEYRAT DRESSING

spindle range

- **Ø 38 - 78mm**
- **Minimal maintenance because of lifetime greased bearings**
- **Greatly simplified integration and installation due to air cooling**
- **High torque and high performance**
- **Conceptual high rigidity**

# MDS













INFO

STANDARD  
MDS

38 - 78 mm	6'000 - 25'000 rpm	Synchron or Asynchron	150 W to 2,4 kW	5,7 Ncm to 3,3 Nm	Ø8 h4 Ø20 h3 Ø35 h3 Ø40 h3	Grease	Available with asynchronous or synchronous motor with very high torque and up to 25,000 rpm. Optionally, the spindles can be equipped with AE sensor. This makes the MDS spindle family the ideal tool for dressing and grinding.
------------	-----------------------------	--------------------------	-----------------------	-------------------------	-------------------------------------	--------	---

Exclusively developed and manufactured in Switzerland, our well-structured MDS (MEYRAT Dressing Spindle) range includes the perfect combination of technology and characteristics for high-precision dressing and grinding applications.

The spindles can optionally be equipped with Accoustic Emission sensors (AE sensors).

-  Diameter
-  Length (mm)
-  Connecting orientation
-  Motor type
-  RPM (min<sup>-1</sup>)
-  Tool interface
-  Power (w)
-  Torque
-  Lubrication
-  Other
-  Article Nr

# MDS-38

MEYRAT DRESSING SPINDLES

**MDS-38**  
**RADIAL**  
 718-01-00  
 as example

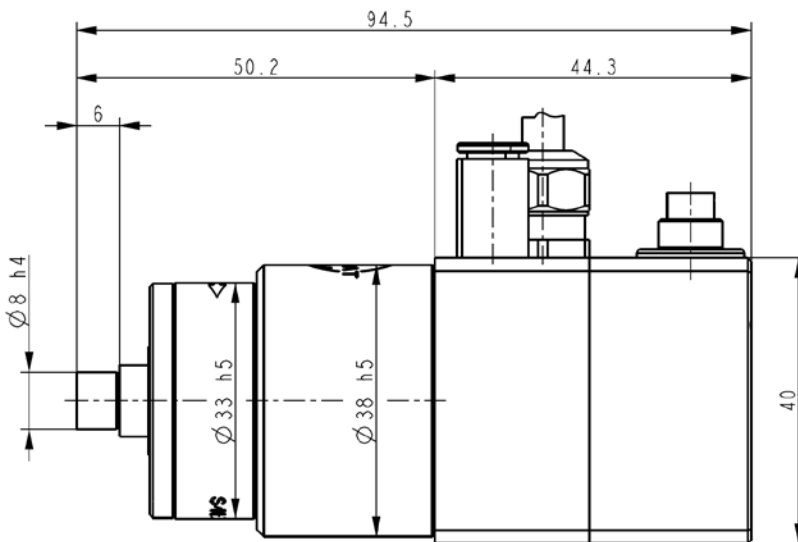
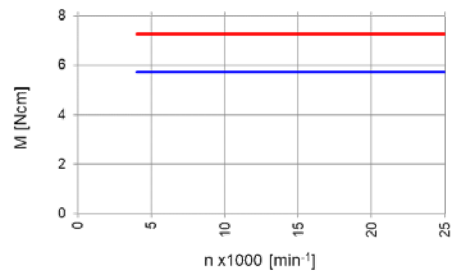
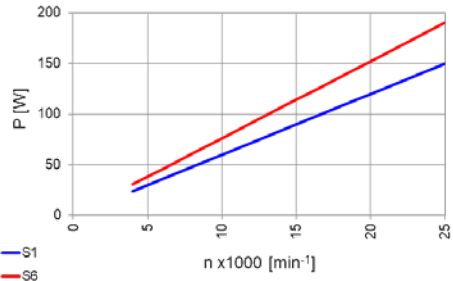
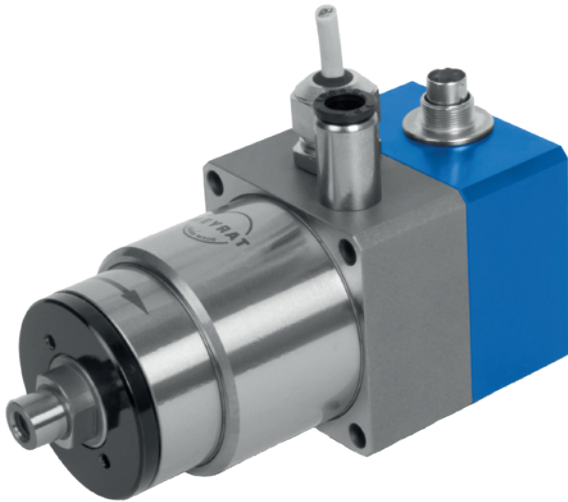

STANDARD <b>MDS</b>	38 mm	78 mm	Radial	Synchron	25'000 rpm	$\varnothing 8$ h4	S1=150 W S6=190 W	S1=5.7 Ncm S6=7.3 Ncm	Grease	Air cooling	718-08-00
		94.5 mm								AE*-Sensor Elaso	718-01-00
										Air cooling	

\*acoustic emission

**MDS**



# MDS-58

MEYRAT DRESSING SPINDLES



**MDS-58**  
**RADIAL**  
173-37-00  
as example

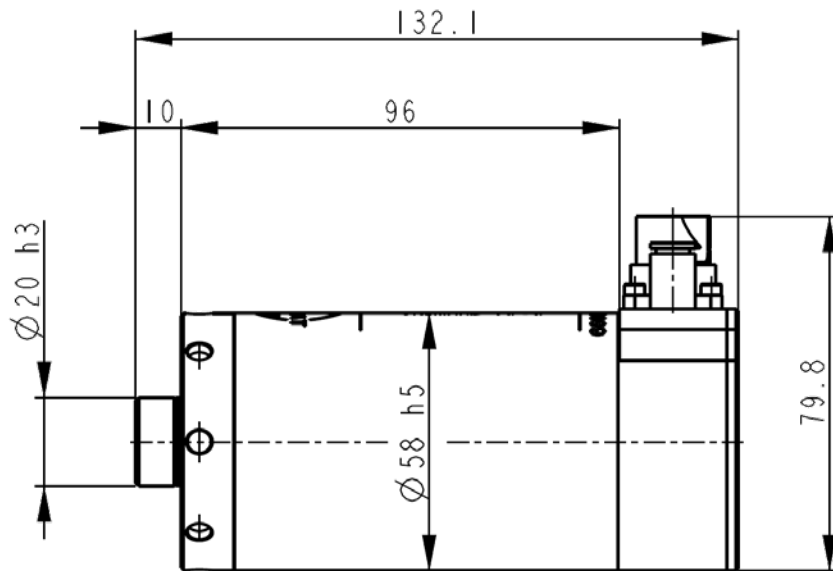
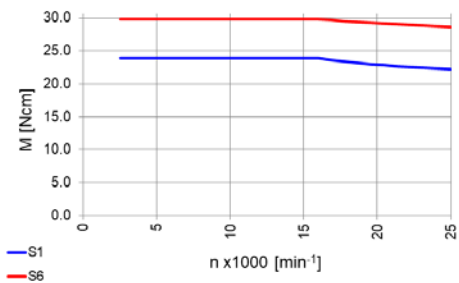
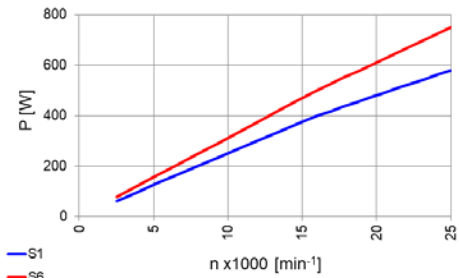

STANDARD <b>MDS</b>	58 mm	Radial	Synchron	25'000 rpm	Ø20 h3	S1=580 W S6=750 W	S1=23.9 Ncm S6=29.8 Ncm	Grease	Air cooling	173-37-00	
									132.1 mm	AE-Sensor Dittel Marposs	173-33-00
									159.8 mm	Air cooling	
									147.1 mm	AE-Sensor Elaso	173-36-00
146.5 mm	Air cooling										
								AE-Sensor SBS	173-34-00		
								Air cooling			

**MDS**

# MDS-72

MEYRAT DRESSING SPINDLES

**MDS-72**  
**RADIAL**  
718-03-00  
(Elaso AE Sensor)  
as example

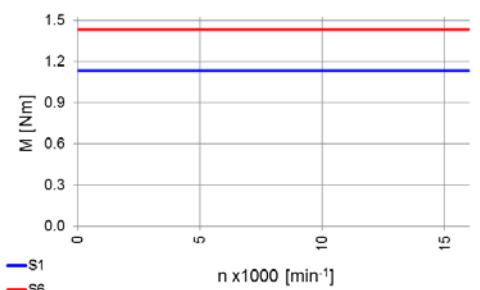
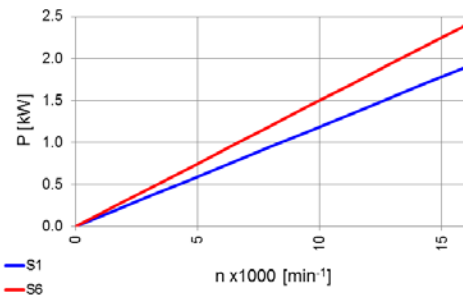
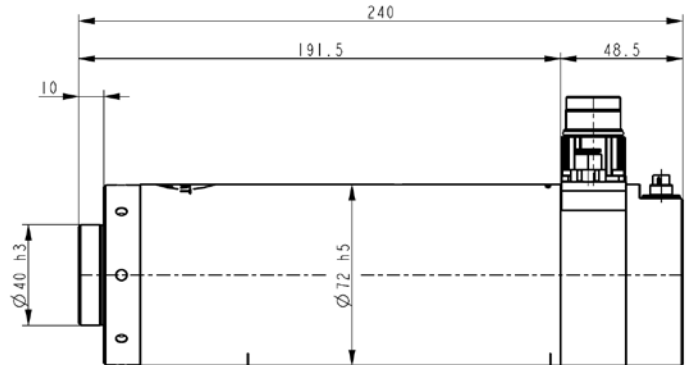

**MDS-72**  
**RADIAL**  
718-50-00  
as example

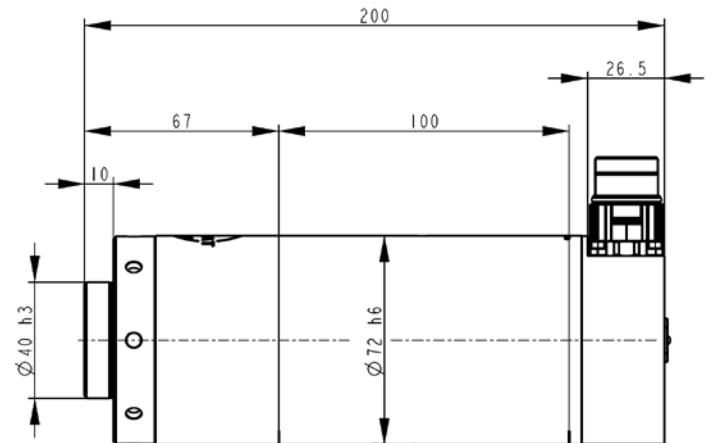

STANDARD <b>MDS</b>	72 mm	Radial	Synchron	Ø40 h3	16'000 rpm		Grease	PERFORMANCE	
					S1=2.6 KW	S1=1.8 Nm		Air cooling	718-05-00
					S6=3.2 KW	S6=2.1 Nm		AE-Sensor Elaso, SBS or Dittel*/Air cool.	718-03-00 718-25-00 718-06-00
								Air cooling	718-50-00
					8'000 rpm			STANDARD	
					S1=1.4 KW	S1=1.6 Nm		PERFORMANCE	
					S6=1.8 KW	S6=2.1 Nm		STANDARD	
								PERFORMANCE	
								STANDARD	

\*DITTEL MARPOSS

**MDS**

# MDS-76/78

MEYRAT DRESSING SPINDLES



## MDS-76 RADIAL

718-18-00  
as example

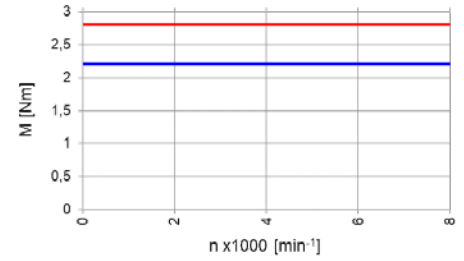
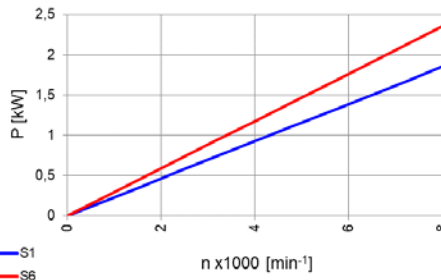
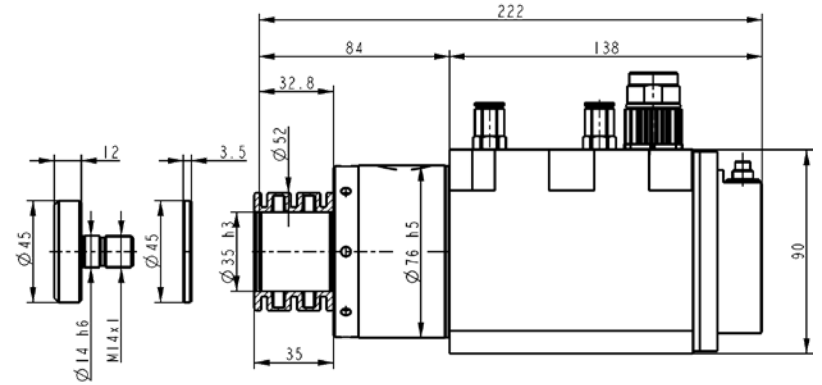

## MDS-78 RADIAL

718-19-00  
as example

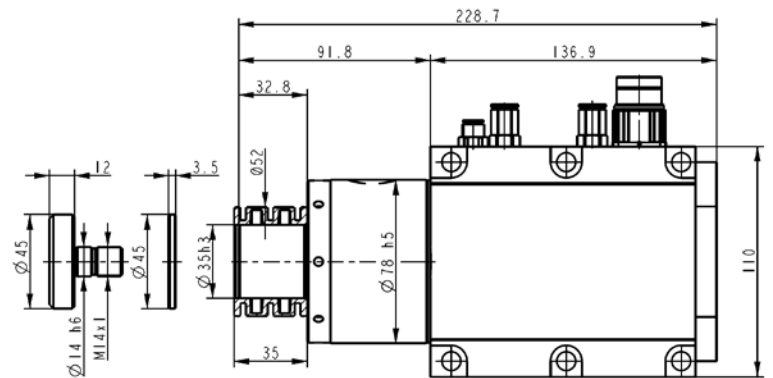

STANDARD MDS	76 mm	203.5 mm	Radial	Synchron	Ø35 h3	S1=1850 W S6=2135 W	S1=2.2 Nm S6=2.6 Nm	Grease	Water cooling	718-22-00
		222 mm							AE-Sensor	718-18-00
	78 mm	228.7 mm							Water cooling	718-19-00
		247.2 mm							AE-Sensor	718-13-00

# MEYRAT standard spindle system

(exempt ATC)

All the **MEYRAT standard spindle ranges** compehence a specifically developed accessories kit that gives you the value add:

- Best performance for your applications
- Optimal control
- Easy and quick installation (plug-and-go)

## CLAMPING SYSTEM

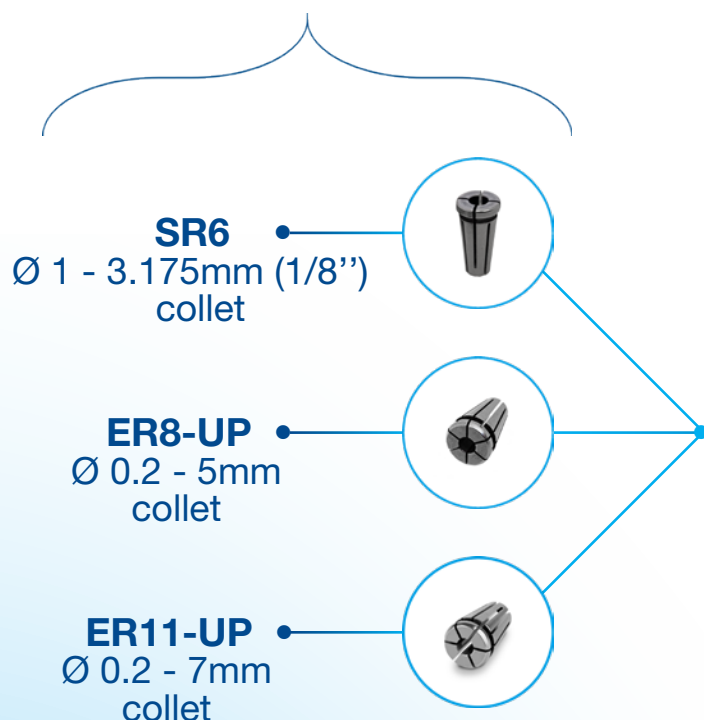

## SPINDLES

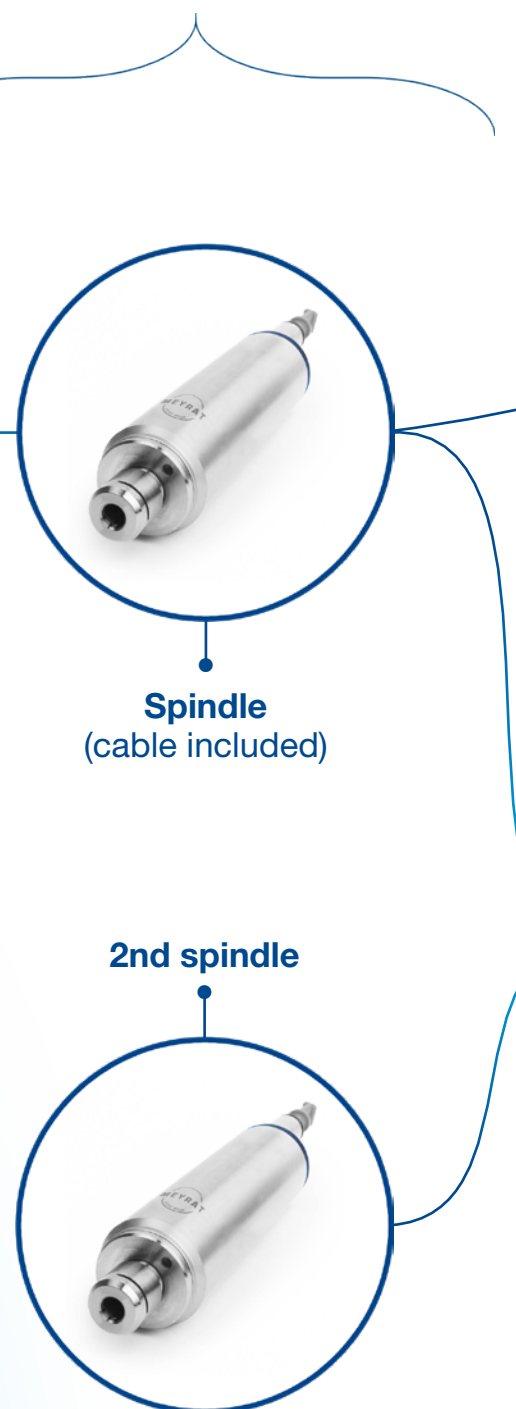

## POWER SUPPLY

## COMPRESSED AIR SUPPLY

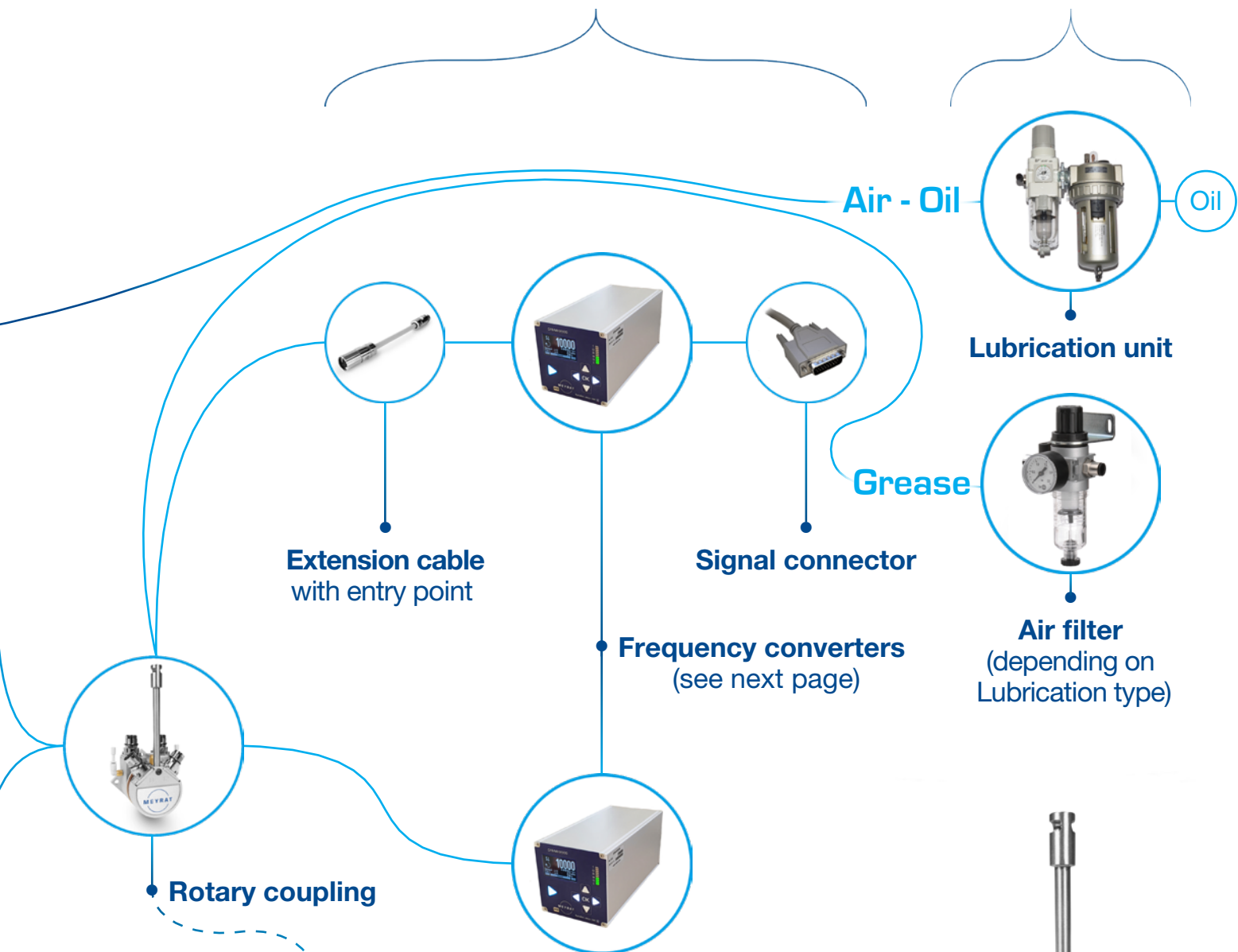

## Coupler

### MEYRAT Rotary coupling Typ JTE-RC-2MM

- Cable management: the cable system is free of tension made by spindle rotations.
- Allows to connect 2 grease lubricated spindles to the same coupler.



# MEYRAT ATC spindle system

The **MEYRAT ATC spindle range** also compehence a specifically developed accessories kit that gives you the value add:

- Best performance for your applications
- Optimal control
- Easy and quick installation (plug-and-go)
- Quick and precise tool change

## CLAMPING SYSTEM

## SPINDLE

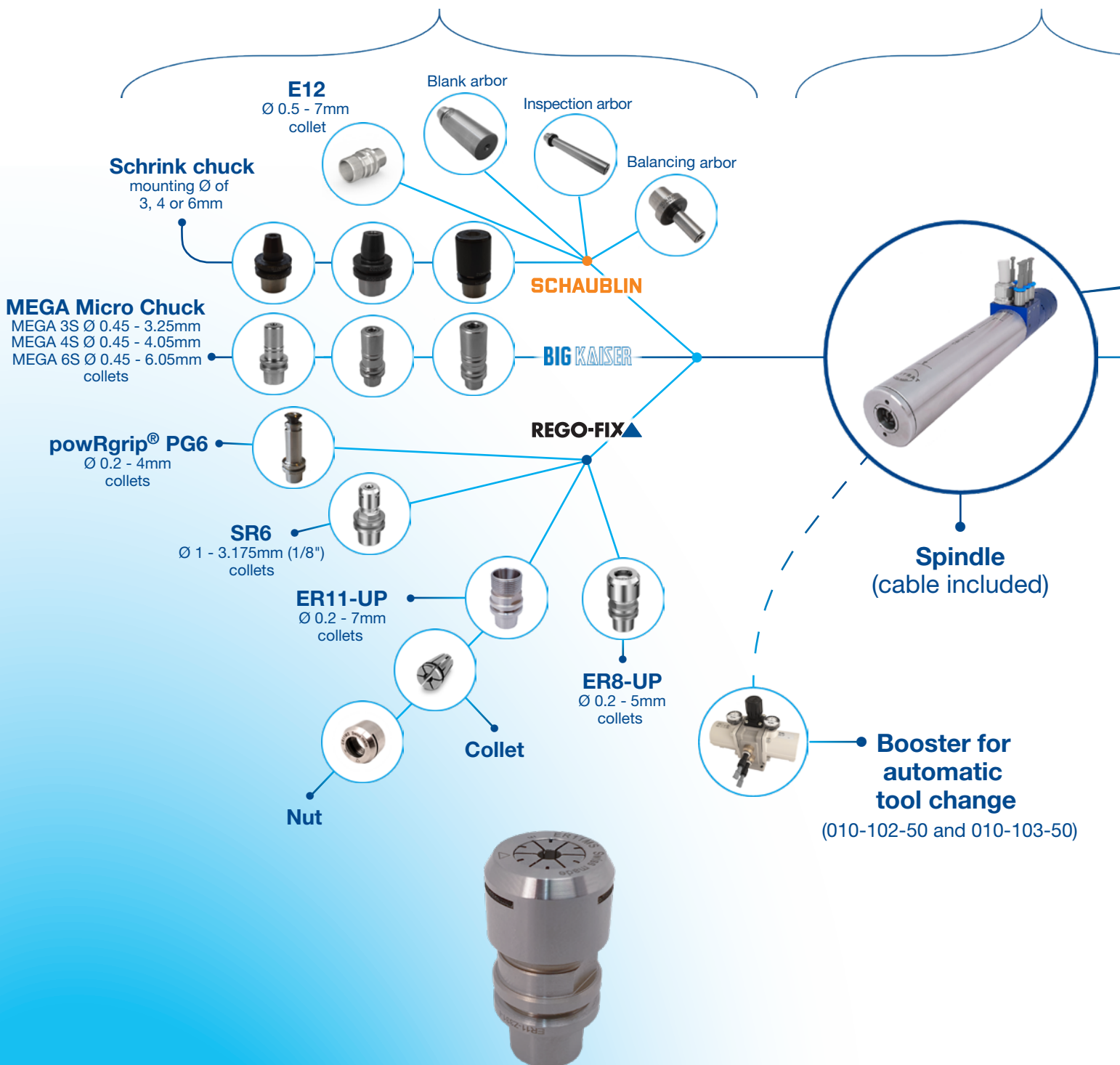

## POWER SUPPLY

## COMPRESSED AIR-SUPPLY

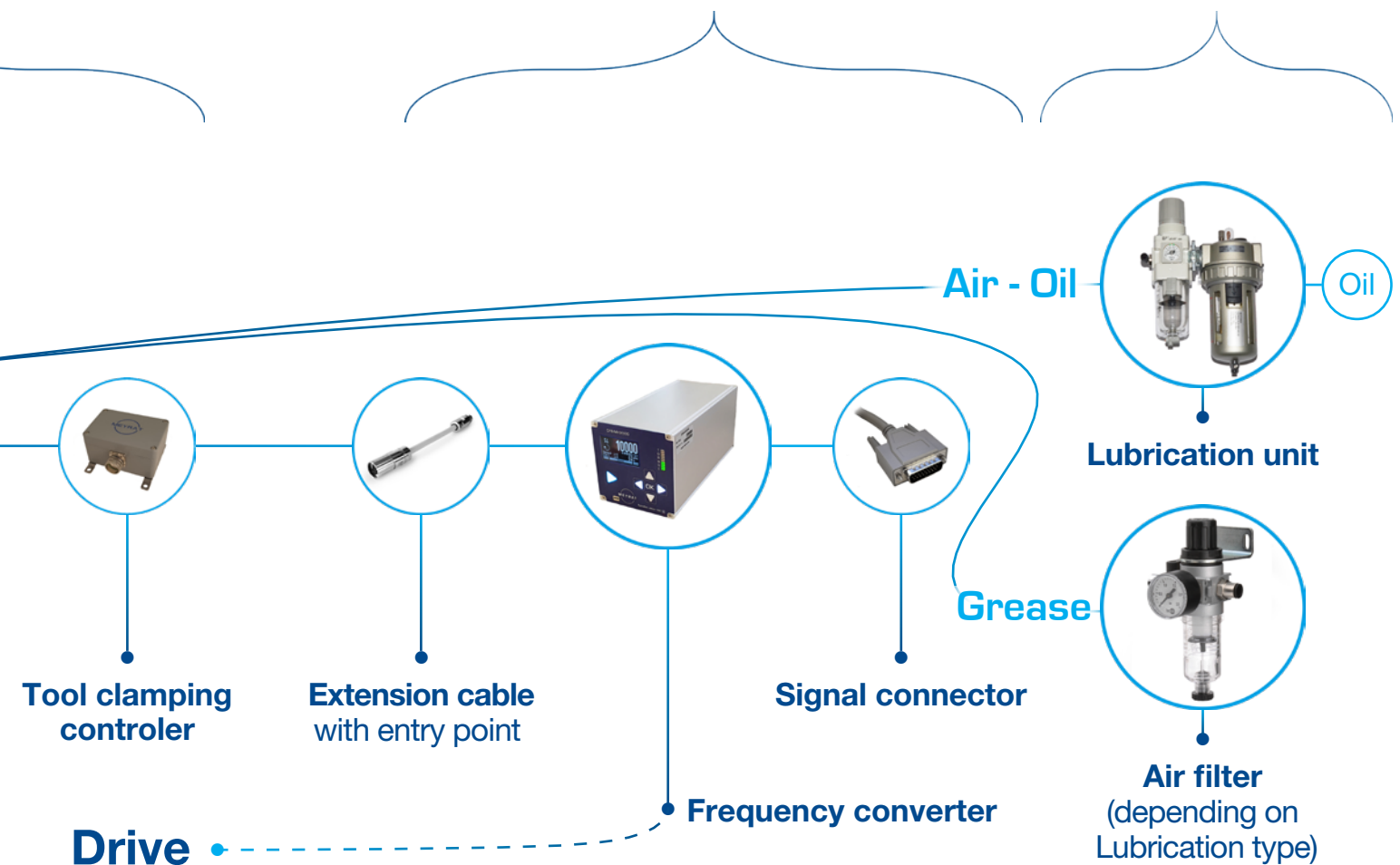

## Drive

### MEYRAT Frequency converter Type CFB-MHX500



#### Advantages and technical features:

Fully optimised for the use of MEYRAT spindles, the CFB-MHX500 frequency converters enable the ideal operation of any range of standard MEYRAT spindles with diameters from 16 to 30mm. Offering more versatility, the CFB-MHX500 Frequency Converter offers a range of features reworked to provide more efficiency and benefits, including:

- Plug and play for quick and easy installation
- Allows to drive 2 spindles sequentially
- Increased security with STO function
- Operating range for low speed machining
- Improved tool life by minimizing drift current
- Optimized for MEYRAT spindles from Ø 16 to 30mm
- Micro-USB accessible from the front











# MEYRAT accessories table

<b>DRIVE</b>		Single output frequency converter with interface	CFB-MHF501A
		Single output frequency converter with interface with front plate	CFB-MHX501T
		Double output frequency converter with interface	CFB-MHX502A
		Double output frequency converter with interface with front plate	CFB-MHX502T
		Base plate for frequency converter	CFB-3739
	<b>SIGNAL CONNECTOR</b>		Signal connector

<b>ROTARY COUPLING</b>		Coupler for 2 spindles	JTE-RC-2MM
------------------------	---	------------------------	------------

<b>CABLES</b>		Extension cable 2m with screw connection	RAL-AD9-AP9-2
		Extension cable 3m with screw connection	RAL-AD9-AP9-3
		Extension cable 5m with screw connection	RAL-AD9-AP9-5
		Extension cable 7m with screw connection	RAL-AD9-AP9-7
		Extension cable 9m with screw connection	RAL-AD9-AP9-9

<b>AIR-OIL</b>	<b>LUBRICATION</b>		Basis lubrication unit	DLB-MHX
			Lubrication unit with controller	DLB-MHX-CEVII
			Additional lubrication unit	DLB-MHX-AD
	<b>OIL</b>		Corex HLP ISO VG 32 1 liter	AHU-CorexHLP32
	<b>AIR FILTER</b>		Air filter unit G1/4 (2,5 bar)	DLB-SPN20
			Air filter unit G1/4 (4 bar)	DLB-SPN20X

<b>ATC</b>	<b>TOOL CLAMPING CONTROLLER</b>		Tool clamping controller	CAP-ATC-1
	<b>BOOSTER</b>		Booster for automatic tool change	MPR-VBA10AF02GLS
	<b>CLEANING CONE</b>		E15 cleaning cone	HSK-ATCE15
	<b>CONTROL PINULE</b>		HSK-E15 Control pinule	TAS-ATC-E15-CTRL
	<b>COMPENSATION STRIPS</b>		Compensation strips	TAS-ATC-E15-EQ
	<b>TENSION STRIPS</b>		Tension strips	TAS-ATC-E15-EB



**MEYRAT SA**  
Lengnaustrasse 10  
CH-2504 Biel/Bienne

[www.meyrat.com](http://www.meyrat.com)  
[info@meyrat.com](mailto:info@meyrat.com)  
[sales@meyrat.com](mailto:sales@meyrat.com)

**T +41 32 344 70 20**  
**F +41 32 344 70 29**



<b>TOOL HOLDERS</b>	<p>TOOL HOLDER (delivered with nut)</p>	<b>SCHAUBLIN</b>  <b>BIG KAISER</b>  <b>REGO-FIX</b>	3mm shrink chuck tool holder
			4mm shrink chuck tool holder
			6mm shrink chuck tool holder
			E12 tool holder
			MEGA3S tool holder
			MEGA4S tool holder
			MEGA6S tool holder
			ER8 tool holder
			ER11 tool holder
			SR6 tool holder
			powRgrip® PG6 tool holder

<b>NUTS</b>	<p>NUT</p>	Nut E12
		Nut MEGA3S
		Nut MEGA4S
		Nut MEGA6S
		Nut SR6
		Nut ER8-UP
		Nut ER11-UP
		Nut SR6

<b>COLLETS</b>	<p>COLLET</p>	E12/0.5 - 7.0 mm	<b>SR6 COLLETS</b>	Clamping collet 1,0 mm
		MEGA3S-25T-75T/0.45 - 3.25 mm		Clamping collet 1,5 mm
		MEGA4S-60T-75T/0.45 - 4.05 mm		Clamping collet 2,0 mm
		MEGA6S-45T-120T/0.45 - 6.05 mm		Clamping collet 3,0 mm
		SR6/1.0 - 3.175 mm		Clamping collet 1/8" [3,175 mm]
		PG6 powRgrip®/0.2 - 4.0 mm		
		ER8-UP/1.0 - 5.0 mm		
		ER11-UP/1.0 - 7.0 mm		



People. Passion. Precision.  
Spindles since 1947. 

