

THE DRESSING SPINDLE FAMILY FROM MEYRAT

MDS - MEYRAT DRESSING SPINDLES

The new spindle family \varnothing 38-58-72-76-78 mm includes the perfect combination of technology and characteristics for high-precision dressing and grinding applications.

Available with both asynchronous and synchronous motor with very high power up to max. 25'000 rpm. Optionally, the spindles can be equipped with Acoustic Emission Sensors (AE sensor). This makes the MDS spindle family definitely the ideal tool for dressing and grinding with:

- Minimal maintenance thanks to lifetime greased ball bearings
- Simplified integration and installation thanks to its conception
- High performance due to high torque
- High rigidity due to design



MDS-72
718-03-00 / 718-25-00



STANDARD MDS	72 mm	200 mm	7'000 rpm	Asynchronous	\varnothing 40 h3	Grease	Air cooling	376-37-00
		220 mm 227.7 mm					AE-Sensor* (Elaso, SBS or Dittel**)/ Air cooling	376-38-00 376-50-00 376-46-00
		200 mm	16'000 rpm	Synchronous			Air cooling	376-39-00
		220 mm 227.7 mm					AE-Sensor* (Elaso, SBS or Dittel**)/ Air cooling	376-40-00 376-51-00 376-47-00
		220 mm		Air cooling			718-05-00	
		240 mm 247.7 mm		AE-Sensor* (Elaso, SBS or Dittel**)/ Air cooling			718-03-00 718-25-00 718-06-00	

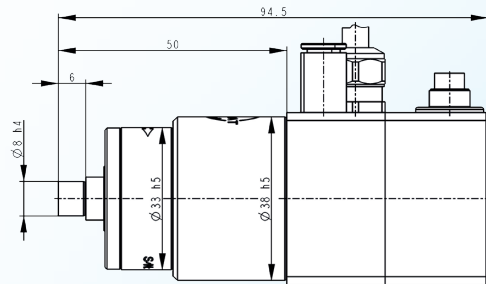
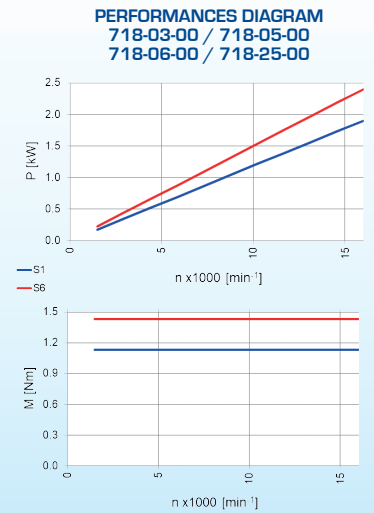

MDS-38
718-01-00



STANDARD MDS	38 mm	78 mm	25'000 rpm	Synchronous	\varnothing 8 h4	Grease	Air cooling	718-08-00
		94.5 mm					AE-Sensor* Elaso / Air cooling	718-01-00

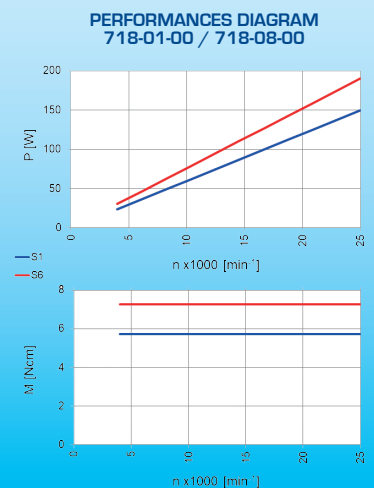

Spindle family for dressing

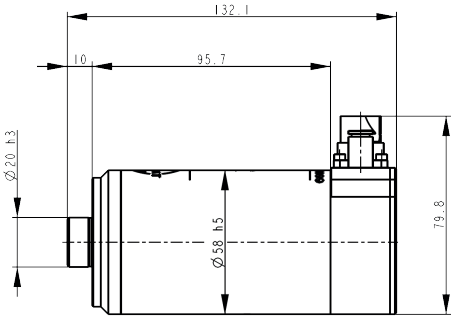

MDS-58
173-37-00



PERFORMANCES DIAGRAM
173-33-00 / 173-34-00
173-36-00 / 173-37-00

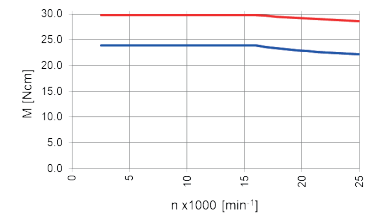
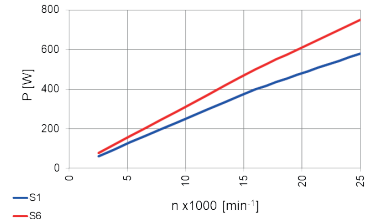

STANDARD MDS	58 mm	132.1 mm	25'000 rpm	Synchronous	Ø20 h3	S1 = 580 W S6 = 750 W	Grease	Air cooling	173-37-00
		159.8 mm						AE-Sensor* Dittel**/ Air cooling	173-33-00
		147.1 mm						AE-Sensor* Elaso / Air cooling	173-36-00
		146.5 mm						AE-Sensor* SBS / Air cooling	173-34-00

MDS-76
718-18-00

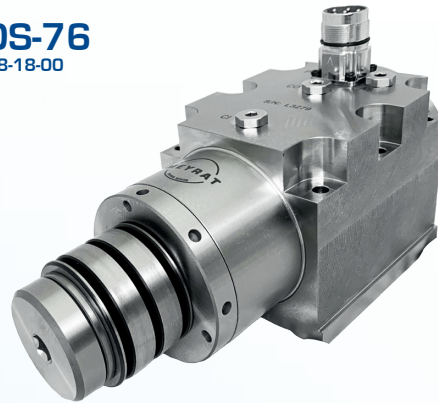
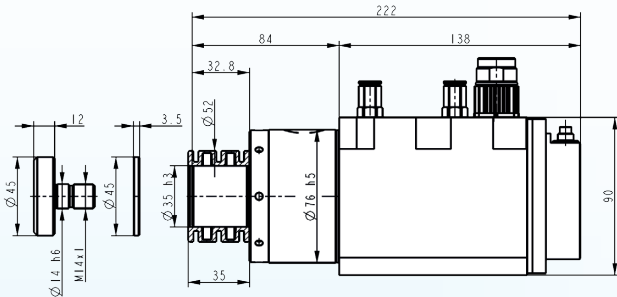

PERFORMANCES DIAGRAM
718-18-00 / 718-22-00

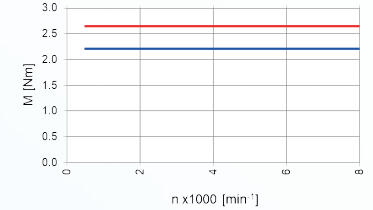
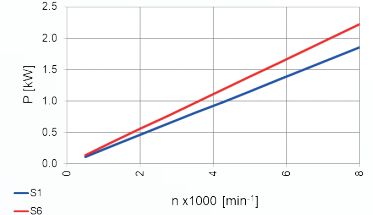

STANDARD MDS	76 mm	203.5 mm	8'000 rpm	Synchronous	Ø35 h3	S1 = 1850 W S6 = 2135 W	Grease	Water cooling	718-22-00
		222 mm						AE-Sensor* Elaso / Water cooling	718-18-00

MDS-78
718-19-00

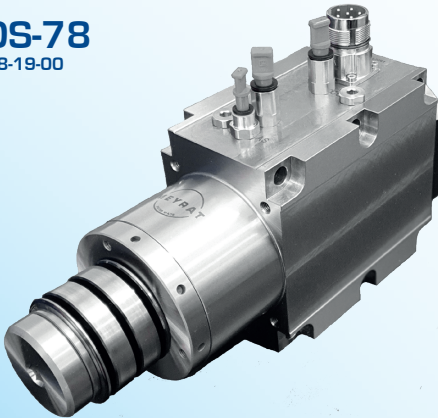
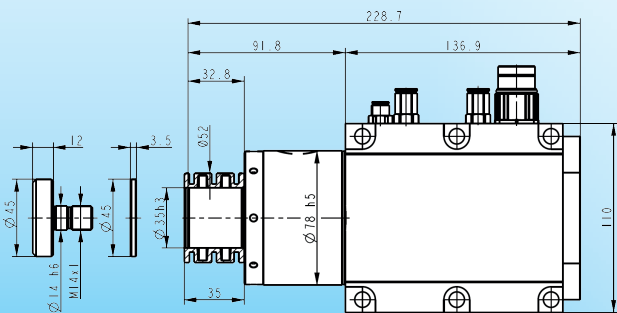

PERFORMANCES DIAGRAM
718-13-00 / 718-19-00

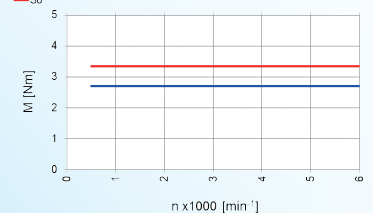
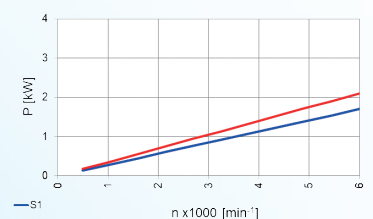

STANDARD MDS	78 mm	228.7 mm	6'000 rpm	Synchronous	Ø35 h3	S1 = 1700 W S6 = 2100 W	Grease	Water cooling	718-19-00
		247.2 mm						AE-Sensor* Elaso / Water cooling	718-13-00